

Vermont Department of Environmental Conservation

Watershed Management Division, Rivers Program

One National Life Drive – Main 2

Montpelier, VT 05620-3522

<http://dec.vermont.gov/watershed>*Agency of Natural Resources*

[cell] 802-345-3510

[fax] 802-828-1544

[phone] 802-828-1535

AUTHORIZATION TO CONDUCT STREAM ALTERATION ACTIVITIES

Pursuant to Section C.2.3 of the Vermont Stream Alteration General Permit

Project Number: **SA-05-013-2016 Plymouth Macawee Road Bank Stabilization**

Applicant Name: Town of Plymouth Highway Department

Mailing Address: 68 Town Office Road, Plymouth, Vermont 05056

Project Location: Macawee Road TH 39 along Macawee Brook

Contact: Larry Lynds

Phone: 802-672-3535

Email: asstclerk@plymouthvt.org

The Secretary of the Vermont Agency of Natural Resources (VT ANR) has determined that:

1. This project authorizes stream bank stabilization on Macawee Road following T.S. Irene damage to include placed rip-rap wall on the road embankment and reconstruction of an existing fordway on Macawee Brook.
2. The proposed activity is eligible for coverage under the VT ANR Stream Alteration General Permit pursuant to Section C.2.3 Reporting Activities.
3. The proposed activity will meet the terms and conditions of Section C.2.3 of the General Permit provided:
 - a) The project will be completed and approved as shown on the attached plans and sketches as approved by the Vermont Agency of Natural Resources and attached herein.
 - b) The project will not adversely affect the public safety by increasing flood hazards.
 - c) The project will not significantly damage fish life or wildlife.
 - d) The project will not significantly damage the rights of riparian owners.
 - e) The project will not obstruct the movement of aquatic life indigenous to the waterbody beyond the actual duration of construction.
 - f) The project is conducted in a manner which minimizes or avoids any discharge of sediment or other pollutants to surface waters in violation of the VT Water Quality Standards.
 - g) The ANR River Management Engineer is notified by phone or email when construction begins and when the project is complete.
 - h) In-stream working dates for all GP activities are from July 1st through October 1st; any in-stream work outside these dates will require an Individual Stream Alteration Permit authorization by the River Management Engineer.
 - i) This authorization has been posted for ten day public comment. This authorization constitutes final approval.

If there are any changes in the project plan or deviation in construction from the plan, the Permittee must notify the River Management Engineer immediately.

If the project is constructed as you have described, as shown on the above referenced approved plans and according to the above conditions, there is no reason to expect any violation of Vermont Water Quality Standards.

Signed this 12th day of August, 2016

Alyssa B. Schuren, Commissioner

Department of Environmental Conservation

This permit expires October 1, 2017.

by: by: _____
Todd Menees, P.E., P.H., River Management Engineer

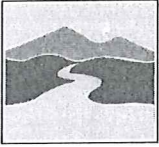

Application and Reporting Form
for coverage under the Stream Alteration Permit
 1022 & 7503 And 10 VSA, CHAPTER 41, SUBCHAPTER 2

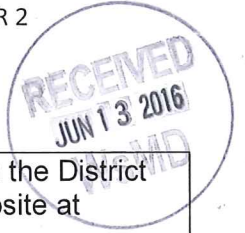

For Stream Alteration Permitting Use Only
 Application Number: SA-05-013-2014

It is strongly recommended prior to your submission of this application to have a site visit with the District Engineer in your area. For engineer and district contact information, please visit our website at http://dec.vermont.gov/sites/dec/files/wsm/rivers/docs/RME_districts_12.14.pdf

Site Visit Date: 5/10/2016 Engineer present: TODD MENEES

Please select the application type below

Individual Permit Application <input type="checkbox"/> \$350.00	General Permit Application <input checked="" type="checkbox"/> \$200.00	Reporting Activity not requiring an application <input type="checkbox"/> \$200.00
--	--	--

A. Applicant Contact Information:

1. Name: TOWN OF PLYMOUTH
 2a. Mailing Address: 68 TOWN OFFICE ROAD
 2b. Town: PLYMOUTH 2c. State: VT 2d. Zip: 05056
 3. Phone: 802-672-3535 4. Email: ASSTCLERK@PLYMOUTH.ORG

B. Landowner (if different than applicant):

1. Name: TOWN OF PLYMOUTH
 2a. Mailing Address: SAME
 2b. Town: 2c. State: 2d. Zip:
 3. Phone: 4. Email:

C. Project Location:

1. Address: 39 MACAWEE ROAD 2. Town: PLYMOUTH
 3. River: UNNAMED TRIBUTARY BROAD BROOK Please follow this link to the [ANR Atlas Map](#)
 4a. Latitude: 4b. Longitude:

D. Contractor:

1. Name: UNKNOWN 2. Phone:
 3. Email:

E. Consultant:

1. Name: PLYMOUTH HIGHWAY Dept. 2. Phone: 802-672-3535
 3. Email:

F. Project Description:

POST-IRENE ROAD RECONSTRUCTION TH 39
 PLACED RAP-RIP WALL AND FORDWAY RECONSTRUCTION

G. Please check the required attachments: (additional information may be required after initial application review)

- Location Map
- Project design drawings including: plan view, cross sections, existing & proposed conditions, bankfull width (channel width at high water)
- For individual and General Permits: List of adjoining landowners; names and complete addresses.

H. Applicant Certification for Reporting Activity Only:

I hereby certify that the information on this application is, to the best of my knowledge, true and accurate. I recognize that by signing this application I am giving consent to employees of the State to enter the subject property for the purpose of processing this application and for ensuring compliance with subsequent agency decisions relating to the project.

Applicant Signature: Sandie Small Date: 6-7-16
Town Clerk

I. Applicant Certification for General and Individual Permits:

**For Stream Alteration General and Individual Permit Applications:
Applicant must file copy of this application with the Town Clerk and Adjoiners.**

I hereby certify that the information on this application is, to the best of my knowledge, true and accurate and that I have provided a copy of this application to the select board and town clerk of the municipality in which this activity is located, the local and regional planning commissions, and to each adjoining landowner as required in the Vermont Stream Alteration Rule. I recognize that by signing this application I am giving consent to employees of the State to enter the subject property for the purpose of processing this application and for ensuring compliance with subsequent agency decisions relating to the project.

Applicant Signature: Sandie Small Date: 6-7-16
Town Clerk
Print Full Name: SANDIE SMALL

If the project is occurring on property other than your own, please include additional signatures below:

Landowner(s) Signature: _____ Date: _____

Print Full Name: _____

Landowner(s) Signature: _____ Date: _____

Print Full Name: _____

A PERMIT MAY BE REQUIRED FROM THE US ARMY CORPS OF ENGINEERS

For information contact: USA Corps of Engineers, VT Project Office, 8 Carmichael Street Suite 205, Essex Jct VT 05452 802-872-2893

Submit this form and enclose the appropriate application fee listed on the top of page one, payable to:

State of Vermont - Vermont Department of Environmental Conservation
Watershed Management Division - Stream Alteration Permitting
1 National Life Drive, Main 2
Montpelier, VT 05620-3522

Direct all correspondence or questions to Mineral Prospecting Permitting at: ANR.WSMDRivers@vermont.gov
For additional information visit: <http://dec.vermont.gov>

Arthur R. Lynds
1515 LYNDS HILL RD
PLYMOUTH, VT 05056
P: 802-672-3569 F: 802-672-5891
E: ABLEWASTEMANAGEMENT@GMAIL.COM

I, Jeff Gehris, grant permission to Arthur R. Lynds to excavate necessary dirt, debris and minimal trees on the property off Town Highway 39 for the sole purpose of rebuilding Town Highway 39 off Hale Hollow Rd, Plymouth, VT.

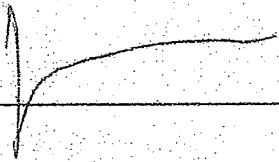
Sign:  _____

Date: 5/30/16

TOWN HIGHWAY # 39

MACKAWEE ROAD (OFF HALE HOLLOW)

SECTION # 1: 125' LONG LAID WALL TO REBUILD ROAD

SECTION # 2: 50' LONG LAID WALL TO REBUILD ROAD

SECTION # 3: FORD-WAY ACROSS BROOK

PERMIT IN TOWN'S NAME

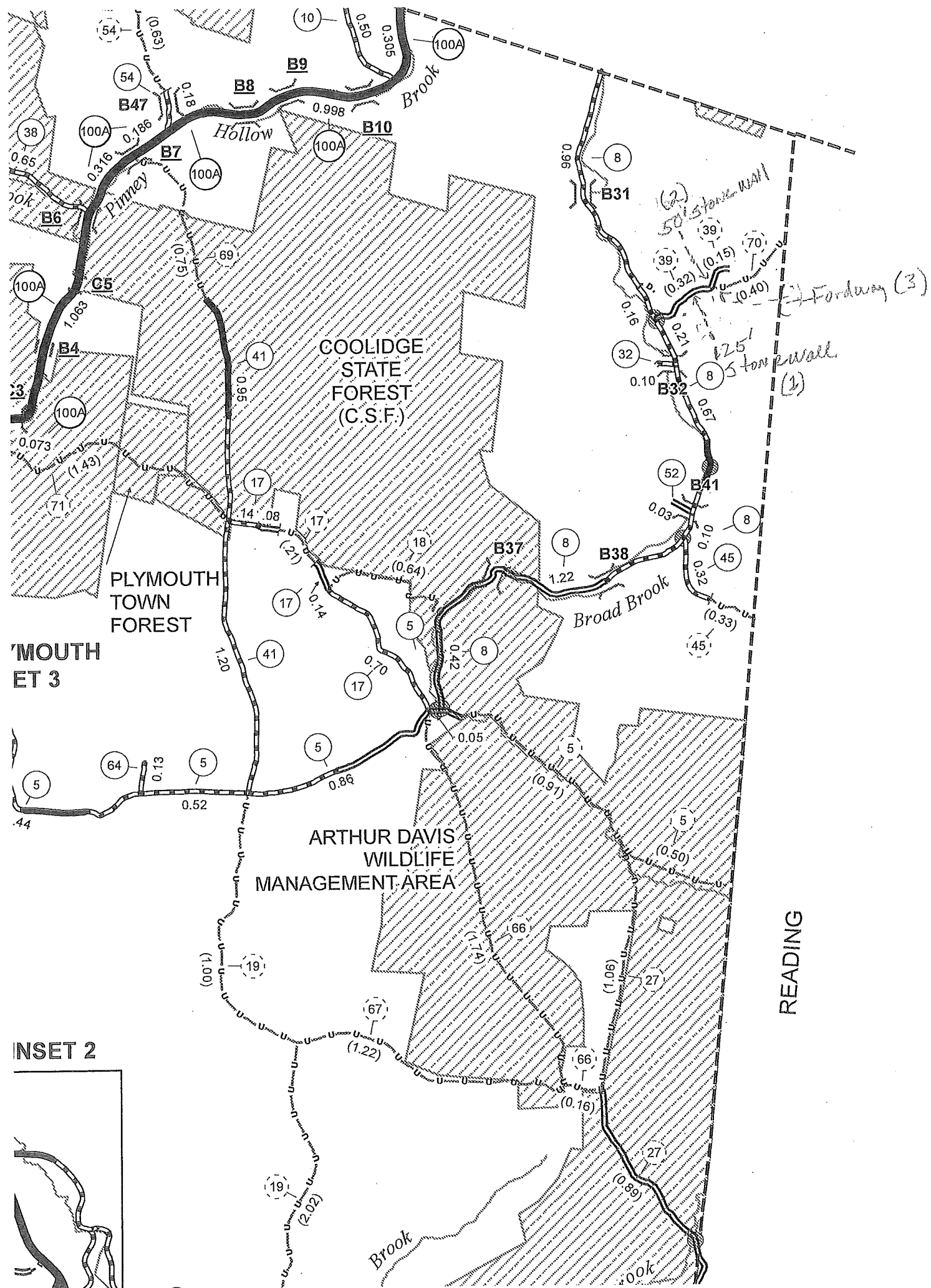

INSET 2

READING

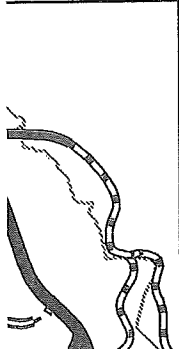

CONCEPTUAL DESIGN PLANS/DETAILS

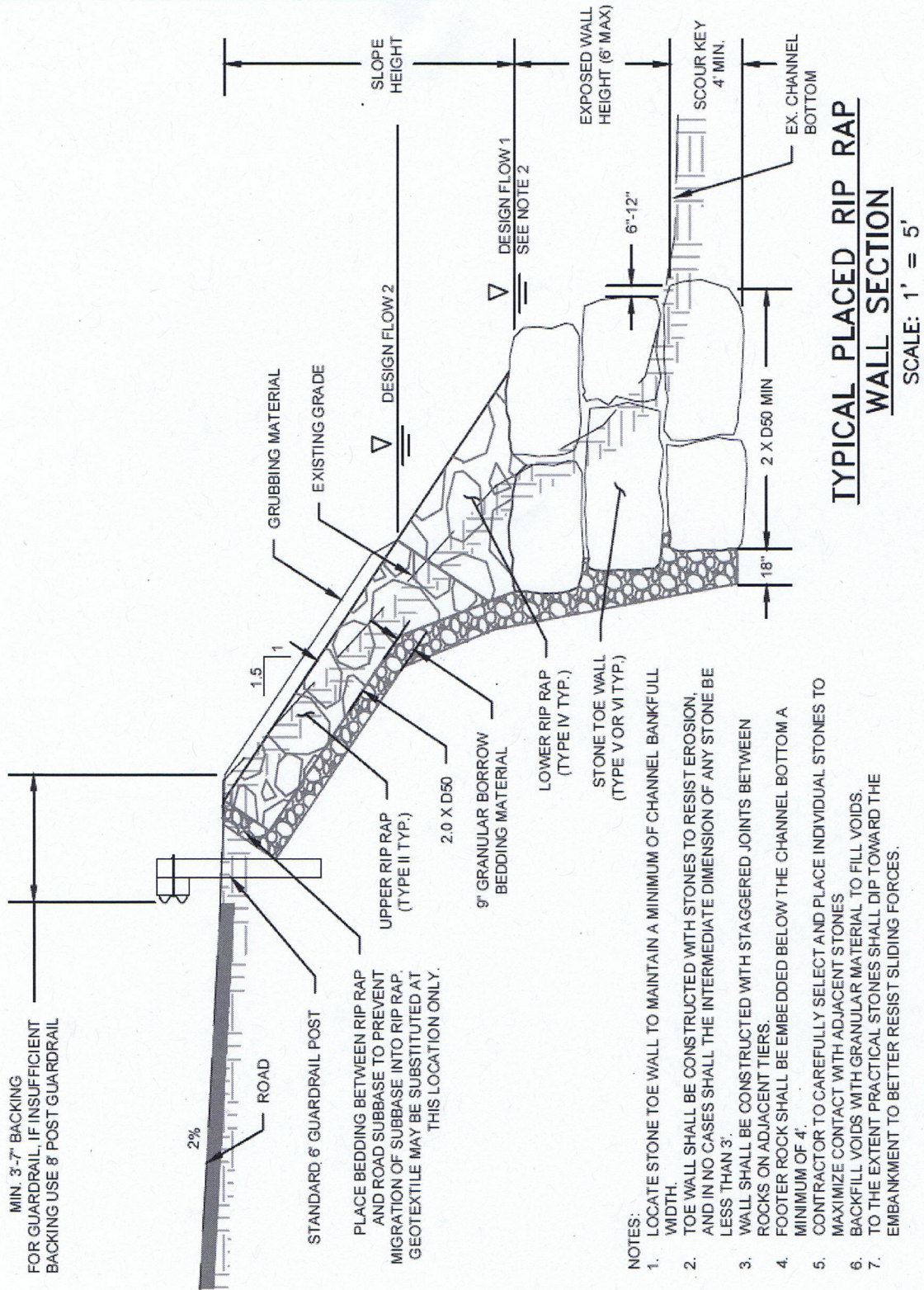

- NOTES:
1. LOCATE STONE TOE WALL TO MAINTAIN A MINIMUM OF CHANNEL BANKFULL WIDTH.
 2. TOE WALL SHALL BE CONSTRUCTED WITH STONES TO RESIST EROSION, AND IN NO CASES SHALL THE INTERMEDIATE DIMENSION OF ANY STONE BE LESS THAN 3'.
 3. WALL SHALL BE CONSTRUCTED WITH STAGGERED JOINTS BETWEEN ROCKS ON ADJACENT TIERS.
 4. FOOTER ROCK SHALL BE EMBEDDED BELOW THE CHANNEL BOTTOM A MINIMUM OF 4'.
 5. CONTRACTOR TO CAREFULLY SELECT AND PLACE INDIVIDUAL STONES TO MAXIMIZE CONTACT WITH ADJACENT STONES.
 6. BACKFILL VOIDS WITH GRANULAR MATERIAL TO FILL VOIDS.
 7. TO THE EXTENT PRACTICAL STONES SHALL DIP TOWARD THE EMBANKMENT TO BETTER RESIST SLIDING FORCES.

Figure 5.2-3: Placed riprap wall typical detail. (Source: Dubois & King and Milone & MacBroom, Inc., 5/1/2014)

PLAN VIEW
(SCALE = 1" : _____)

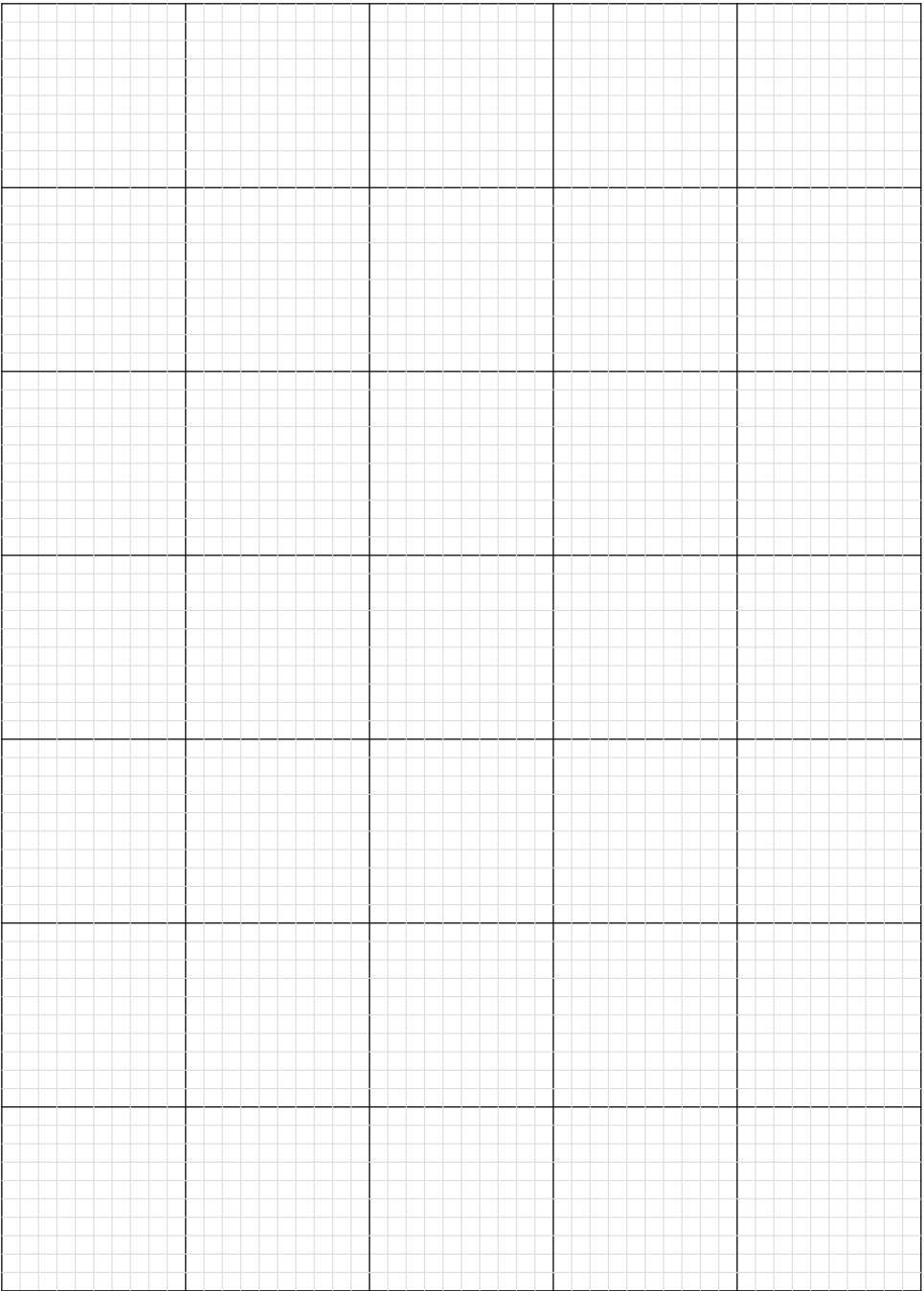

CONSTRUCTION SPECIFICATIONS

CONSTRUCTION OPERATIONS SHALL BE DONE IN SUCH A MANNER THAT EROSION AND WATER POLLUTION ARE MINIMIZED AND HELD WITHIN REASONABLE AND LEGAL LIMITS. STATE AND FEDERAL LAWS SHALL BE FOLLOWED WHEN WORKING IN STREAMS.

MATERIALS

GEOTEXTILE SHALL BE A NON-WOVEN NON-HEAT BONDED NEEDLE-PUNCHED FABRIC HAVING A MINIMUM TENSILE STRENGTH OF 150 LBS. (MIN. AVG. ROLL VALUE) AND WEIGHING A MINIMUM OF 60Z. PER SQUARE YARD.
WHEN MORE THAN ONE WIDTH OF GEOTEXTILE IS REQUIRED, OVERLAP SHALL BE A MINIMUM OF 24 INCHES. TEARS SHALL BE REPAIRED IMMEDIATELY.
ANCHORING PINS SHALL BE PLACED THROUGH THE GEOTEXTILE IN ALL EXCAVATED SECTIONS AND OVERLAPS ON APPROXIMATELY 3 FT. CENTERS. PINS CAN BE MADE OF 8 GAUGE (MIN.) WIRE OR NO. 3 REBAR. PINS SHOULD BE SHARPENED AND CARE TAKEN NOT TO RIP THE FABRIC DURING INSTALLATION.
BASE MATERIAL SHALL BE AASHTO NO. 4 OR SIMILAR COARSE AGGREGATE. A MINIMUM 6 INCH COMPACTED LAYER SHALL BE PLACED ON THE GEOTEXTILE BEFORE PLACEMENT IF THE SURFACING MATERIAL.
SURFACING MATERIAL MAY BE USED OVER THE BASE AGGREGATE IF DESIRED. A MINIMUM OF 2" SHALL BE USED. AGGREGATE FOR SURFACE MAY BE CRUSHED STONE, GRAVEL, OR SLAG. FINE MATERIAL (NATURALLY CONTAINED OR ADDED) MAY BE USED TO CONFORM TO THE REQUIREMENTS.

CENTERLINE PROFILE

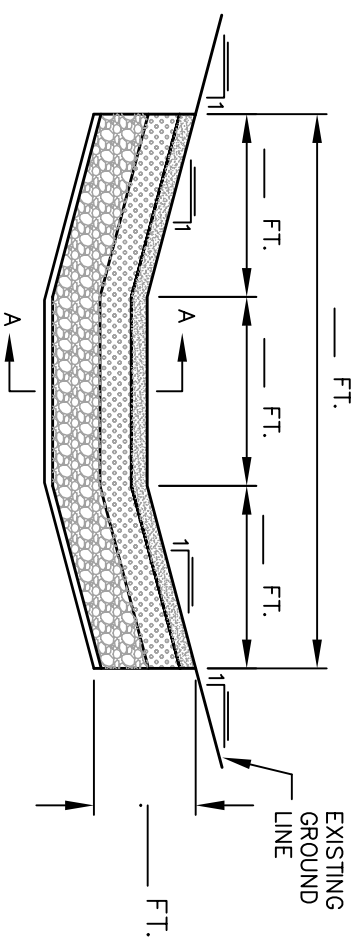

SECTION A-A

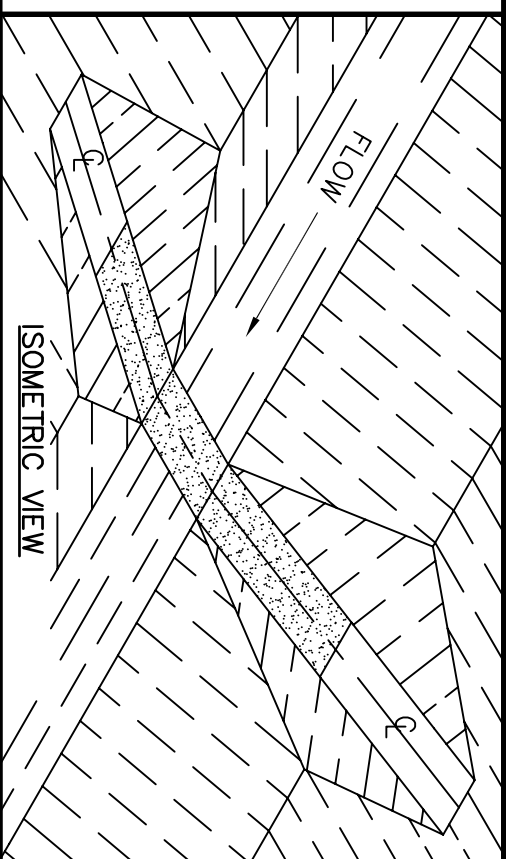
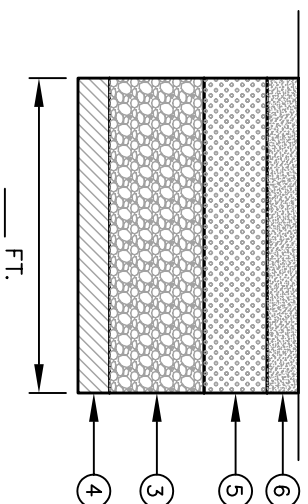

BILL OF MATERIALS

ITEM #	ITEM	QUANTITY	UNIT	CONSTRUCTION SPECIFICATIONS
1.	SITE PREPARATION		JOB	1
2.	EXCAVATION		C.Y.	11
3.	___" QUARRY ROCK OR FIELD STONE		C.Y.	11
4.	GEOTEXTILE (WOVEN) (NON-WOVEN)		S.Y.	54
5.	SURFACING MATERIAL		C.Y.	11
6.	HOOF CONTACT MATERIAL		C.Y.	11
7.	SEEDING & MULCHING		ACRE	52

STREAM CROSSING

HAZARD CLASS
LOW

JOB CLASS

VERMONT



Date _____

Designed _____

Drawn _____

Checked _____

Approved by _____