

76909020

NOV 1 2016 updates

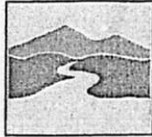

VERMONT DEPARTMENT OF ENVIRONMENTAL CONSERVATION
WATERSHED MANAGEMENT DIVISION
STORMWATER PROGRAM

Notice of Intent (NOI) for Stormwater Discharges

Associated with Construction Activities on **LOW RISK SITES**

Under Vermont Construction General Permit 3-9020

Submission of this completed Notice of Intent (NOI) constitutes notice that the entities in Section A intend to be authorized to discharge pollutants to Waters of the State, from the project identified in Section 3, under Vermont's Construction General Permit (CGP). Submission of the NOI constitutes notice that the parties identified in Section 1 of this form have read, understand, and meet the eligibility conditions of the CGP; have determined that the project qualifies for coverage as a Low Risk project in conformance with Appendix A of the CGP; agree to comply with all applicable terms and conditions of the CGP; understand that continued authorization under the CGP is contingent on maintaining eligibility for coverage; and that all applicable practices in the Low Risk Site Handbook for Erosion Prevention and Sediment Control must be implemented and maintained for the duration of construction activities. In order to be granted coverage, all information required on this form must be provided and an application fee payable to the State of Vermont must be submitted.

A. Applicant(s) Information

1. Name: Canaan Fire District #1

2a. Mailing Address: PO Box 159

2b. Town: Canaan

2c. State: VT

2d. Zip: 05903

3. Phone: 802-266-3370

4. Email: nlabrecque@canaanschools.org

5. Additional Contact Name/Email (if applicable): Noreen Labrecque

6. Principal Operator (if known):

7a. Mailing Address:

7b. Town:

7c. State:

7d. Zip:

8. Phone:

9. Email:

10. Additional Contact Name/Email (if applicable):

B. Application Preparer / Consultant Information

1. Company: Tata & Howard, Inc.

2. Name: Gary A. Leach, P.E.

3a. Mailing Address: 36 Eastern Avenue, Suite 6

3b. Town: St. Johnsbury

3c. State VT

3d. Zip 05819

4. Phone: 802-748-9009

5. Email: gleach@tataandhoward.com

6. Additional Contact Name/Email (if applicable):

C. Project Information (all fields are required)

1. Project Name: Water Storage Tank

2a. Is this project part of a Common Plan of Development?

Yes

No

2b. If yes, name of Development:

3a. Does this project have any previously issued or pending stormwater discharge permits?

Yes

No

3b. If yes, prior NOI number(s):

4a. Physical Address of Project: 32-152 Green Hill Road

4b. Town: Canaan

4c. County: Essex

Project Coordinates (project center in Decimal Degrees with 6 digits to the right of the decimal)

5a. Latitude: 45.005056

5b. Longitude: -71528410

6. SPAN: Enter the 11-digit number that is printed on the property tax bill for the applicable parcel(s). Projects that involve more than 1 parcel shall list all applicable SPANs.

1 2 6 - 0 3 9 - 1 0 7 0 5

7. Name of receiving water(s): Connecticut River

Include a topographic location map - Must provide sufficient information to determine the location of the project. Must be in the form of a USGS topographical map or directional map.

8. Total area of disturbance: 1.97 Acres (<= 5 acres: \$100 per application, > 5 acres: \$220 per application)

9. Brief description of construction activities to be permitted:

Construction of new water storage tank for municipal water systems of Canaan Fire District #1, Canaan Fire District #2 and West Stewartstown Water Precinct (via interconnection). Water storage tank is below ground, cast-in-place concrete. Transmission main is 1,600 LF of 12-inch water main from Christian Hill Road to the Water Storage Tank.

D. Public Notice Requirement

Prior to submitting the complete NOI for review, you must provide a copy of this complete NOI and related Appendix A to the municipal clerk for posting in the municipality in which the project is located. If the project and the related discharge(s) are located in different municipalities, then the completed NOI must be filed with the municipal clerk in each municipality. In order to be considered complete, you must include the date of posting.

Date of Posting at Municipal Office(s): 11/01/16
Information for the Municipal Clerk regarding posting instructions can be found on Page 3 of this NOI.

* In addition to the NOI and Appendix being posted in the Town Clerk(s) office(s), once the application is deemed administratively complete, the Stormwater Program starts its required 10 day public comment period. This includes sending an email notice to a list of interested parties as well as posting on our Division website for 10 days.

E. Certification Relating to the Accuracy of the Information Submitted

I hereby certify under penalty of law that this document and all attachments were prepared under my direction or supervision in accordance with a system designed to assure that qualified personnel properly gathered and evaluated the information submitted. Based on my inquiry of the person or persons who manage the system, or those persons directly responsible for gathering the information, the information submitted is, to the best of my knowledge and belief, true, accurate, and complete. I am aware that there are significant penalties for submitting false information, including the possibility of fine and imprisonment for knowing violations. I also certify that the applicable practices in The Low Risk Site Handbook for Erosion Prevention and Sediment Control will be implemented for the duration of the project for which this NOI is submitted.

Landowner Name: Town of Canaan. Title: Select Board Chair

Signature: Vernon L Crawford Date: 10-6-16

Principal Operator (if known): _____ Title: _____

Signature: _____ Date: _____

Application Preparer (if applicable): GARY D. LEACH Title: SR. ENGINEER

Signature: Gary Leach Date: 10-31-16

Submit this form, Appendix A, location map, and the \$ 100.00 fee to:

Vermont DEC - Watershed Management Division, Stormwater Program
1 National Life Drive, Main Building Second Floor
Montpelier, VT 05620-3522

PUBLIC COMMENT

Public comments concerning this Notice of Intent to discharge under CGP 3-9020 (amended 2008) are invited and must be submitted within 10 days of receipt of this Notice by the Municipal Clerk. Comments should address how the application complies or does not comply with the terms and conditions of CGP 3-9020 (amended 2008). A letter of interest should be filed by those persons who elect not to file comments but who wish to be notified if the comment period is extended or reopened for any reason. All written comments received within the time frame described above will be considered by the Department of Environmental Conservation in its final ruling to grant or deny authorization to discharge under CGP 3-9020 (amended 2008). Send written comments to:

Vermont Department of Environmental Conservation
Watershed Management Division, Stormwater Program
1 National Life Drive, Main Building Second Floor
Montpelier, VT 05620-3522

Please cite the NOI number in any correspondence

APPEALS

Renewable Energy Projects – Right to Appeal to Public Service Board

If this decision relates to a renewable energy plant for which a certificate of public good is required under 30 V.S.A. §248, any appeal of this decision must be filed with the Vermont Public Service Board pursuant to 10 V.S.A. §8506. This section does not apply to a facility that is subject to 10 V.S.A. §1004 (dams before the Federal Energy Regulatory Commission), 10 V.S.A. §1006 (certification of hydroelectric projects) or 10 V.S.A. Chapter 43 (dams). Any appeal under this section must be filed with the clerk of the Public Service Board within 30 days of the date of this decision. For further information, see the Public Service Board website at <http://psb.vermont.gov> or call (802) 828-2358. The address for the Public Service Board is 112 State Street Montpelier, Vermont 05620-2701.

All Other Projects – Right to Appeal to Environmental Court

Pursuant to 10 V.S.A. Chapter 220, any appeal of this decision must be filed with the clerk of the Environmental Court within 30 days of the date of the decision. The Notice of Appeal must specify the parties taking the appeal and the statutory provision under which each party claims party status; must designate the act or decision appealed from; must name the Environmental Court; and must be signed by the appellant or their attorney. In addition, the appeal must give the address or location and description of the property, project or facility with which the appeal is concerned and the name of the applicant or any permit involved in the appeal. The appellant must also serve a copy of the Notice of Appeal in accordance with Rule 5(b)(4)(B) of the Vermont Rules for Environmental Court Proceedings. For further information, see the Vermont Rules for Environmental Court Proceedings, available online at www.vermontjudiciary.org or call (802) 951-1740. The address for the Environmental Court is 32 Cherry Street, 2nd Floor Suite 303, Burlington, Vermont 05401.

A copy of CGP 3-9020 (amended 2008) may be obtained by calling (802) 828-1535; by visiting the Department at the above address between the hours of 7:45 am and 4:30 pm; or by download from the Watershed Management Division's Web site at: <http://dec.vermont.gov/watershed>

INFORMATION FOR MUNICIPAL CLERK

Please post this notice and instruction sheet in a conspicuous place for 10 days from the date received (per 10 V.S.A. Chapter 47 §1263(b)). If you have any questions, contact the Watershed Management Division of the Department of Environmental Conservation at (802) 828-1535.

APPENDIX A

Part I – Basic Risk Evaluation

A project may automatically be categorized as Low Risk based on a few basic project characteristics. Answer each question below to determine if a project is automatically categorized as Low Risk. For definitions of terms used in the following questions (e.g. disturbance, vegetated buffer) refer to Appendix C.

Basic Risk Evaluation				
	Criteria	Answer	Score Direction	Enter Score
1.	Will the proposed independent project alone disturb more than 2 acres of land?	YES <input type="checkbox"/> NO <input checked="" type="checkbox"/>	If YES, enter 1, if NO enter 0	0
2.	Is the project within a watershed impaired due to stormwater or sediment as specified on Part A of the Vermont 303(d) list?	YES <input type="checkbox"/> NO <input checked="" type="checkbox"/>	If YES, enter 1, if NO enter 0	0
3.	Will the project have any stormwater discharges from the construction site to receiving water(s) that do not first pass through a 50 ft vegetated buffer area?	YES <input type="checkbox"/> NO <input checked="" type="checkbox"/>	If YES, enter 1, if NO enter 0	0
4.	Will the project have disturbed earth in any one location for more than 14 consecutive calendar days without temporary or final stabilization?	YES <input type="checkbox"/> NO <input checked="" type="checkbox"/>	If YES, enter 1, if NO enter 0	0
5.	Will the project have more than five acres of disturbed earth at any one time?	YES <input type="checkbox"/> NO <input checked="" type="checkbox"/>	If YES, enter 1, if NO enter 0	0
Total Score for Basic Risk Evaluation (add score from questions 1-5)				0

If the Total Score for Basic Risk Evaluation is 0, the proposed project is eligible for coverage under this permit as a Low Risk project. Proceed to Part IV of Appendix A for a summary of the application requirements for Low Risk Projects. If not, proceed to Part II.

Criterion 1: Only include the disturbance planned for an independent project. For example, if a lot owner is only building on a single house lot in a residential subdivision, only consider the disturbance associated with that lot, not the entire common plan. Refer to Appendix C for definitions of independent project and disturbance.

Criterion 2: Refer to the following web page for a list of waters in these categories:
http://www.vtwaterquality.org/stormwater/htm/sw_cgpeeligibility.htm

Criterion 3: Refer to the Appendix C for the definition of vegetated buffer area.

Criterion 4: Refer to Appendix C for definitions of temporary and final stabilization.

Criterion 5: Refer to Appendix C for the definition of disturbed earth.



TATA & HOWARD

LETTER OF TRANSMITTAL

DATE: 10/13/2016 JOB NO.: 3447-3

RE: Canaan Fire District #1
Water Storage Tank
Contract #3



ATTN:
TO: Vermont DEC Watershed Mgt Division
Stormwater Program
1 National Life Drive, Main - 2
Montpelier, VT 05620-3522

FROM: Gary Leach, P.E.
Tata & Howard, Inc.
36 Eastern Ave, Suite 6
St. Johnsbury, VT 05819
(802) 748-9009

WE ARE SENDING YOU Attached Under separate cover via _____ the following
ITEMS:
 Shop drawings Prints Plans Samples Specifications
 Copy of letter Change Orders _____

COPIES	DATE	NO.	DESCRIPTION
1			Application for Permit 3-9020 (Submitted previously)
1			Application Fee -Check (Submitted previously)
1			Drawings

THESE ARE TRANSMITTED as checked below:

- For approval Approved as submitted Resubmit _____ copies for approval
- For your use Approved as noted Submit _____ copies for distribution
- As requested Returned for corrections Return _ signed original agreements
- For review and comment _____
- FOR BIDS DUE _____ PRINTS RETURNED AFTER LOAN TO US

REMARKS:

*Any Questions?
gleach@tataandhoward.com.*

COPY TO: _____

SIGNED: Gary A. Leach, P.E.

Main Office Marlborough, MA

Branch Offices Lakeville, MA Meriden & Waterbury, CT Concord, NH Portland, ME St. Johnsbury, VT Flagstaff, AZ

LEGEND		ABBREVIATIONS	
EXISTING	PROPOSED	EXISTING	PROPOSED
—	—	ABD.	ABANDONED
—	—	APPROX.	APPROXIMATE
—	—	AC	ASBESTOS CEMENT PIPE
—	—	CL	CENTER LINE
—	—	CF	CUBIC FOOT (FEET)
—	—	CI	CAST IRON
—	—	CLR.	CLEAR, CLEARANCE
—	—	CMP	CORRUGATED METAL PIPE
—	—	DI	DUCTILE IRON
—	—	ELEV., EL.	ELEVATION
—	—	FM	FORCE MAIN
—	—	HDPE	HIGH DENSITY POLYETHYLENE
—	—	HYD.	HYDRANT
—	—	INV.	INVERT
—	—	LF	LINEAR FEET
—	—	LT	LEFT
—	—	MAX.	MAXIMUM
—	—	MH	MANHOLE
—	—	MIN.	MINIMUM
—	—	NIC	NOT IN CONTRACT
—	—	P	LEDGE PROBE
—	—	PVC	POLYVINYL CHLORIDE
—	—	RCP	REINFORCED CONCRETE PIPE
—	—	RT	RIGHT OF WAY
—	—	RD.	RIGHT
—	—	REQ'D	REQUIRED
—	—	SB	SOIL BORING
—	—	SMH	SEWER MANHOLE
—	—	STA.	STATION
—	—	TBA	TO BE ABANDONED
—	—	TBM	TEMPORARY BENCH MARK
—	—	TBR	TO BE REMOVED
—	—	TBRL	TO BE RELOCATED
—	—	TPR	TEST PIT REQUIRED
—	—	TYP.	TYPICAL

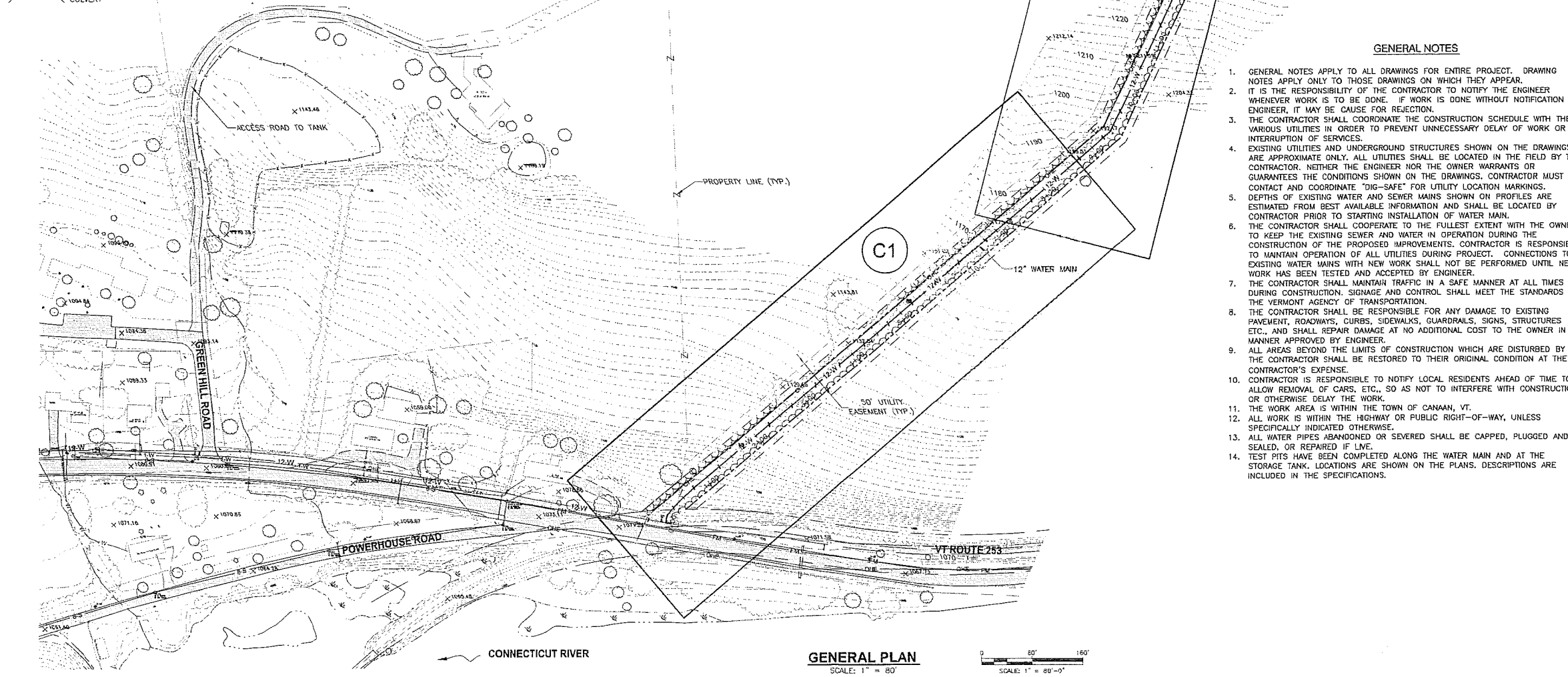

- GENERAL NOTES**
- GENERAL NOTES APPLY TO ALL DRAWINGS FOR ENTIRE PROJECT. DRAWING NOTES APPLY ONLY TO THOSE DRAWINGS ON WHICH THEY APPEAR.
 - IT IS THE RESPONSIBILITY OF THE CONTRACTOR TO NOTIFY THE ENGINEER WHENEVER WORK IS TO BE DONE. IF WORK IS DONE WITHOUT NOTIFICATION TO ENGINEER, IT MAY BE CAUSE FOR REJECTION.
 - THE CONTRACTOR SHALL COORDINATE THE CONSTRUCTION SCHEDULE WITH THE VARIOUS UTILITIES IN ORDER TO PREVENT UNNECESSARY DELAY OF WORK OR INTERRUPTION OF SERVICES.
 - EXISTING UTILITIES AND UNDERGROUND STRUCTURES SHOWN ON THE DRAWINGS ARE APPROXIMATE ONLY. ALL UTILITIES SHALL BE LOCATED IN THE FIELD BY THE CONTRACTOR. NEITHER THE ENGINEER NOR THE OWNER WARRANTS OR GUARANTEES THE CONDITIONS SHOWN ON THE DRAWINGS. CONTRACTOR MUST CONTACT AND COORDINATE "DIG-SAFE" FOR UTILITY LOCATION MARKINGS.
 - DEPTHS OF EXISTING WATER AND SEWER MAINS SHOWN ON PROFILES ARE ESTIMATED FROM BEST AVAILABLE INFORMATION AND SHALL BE LOCATED BY CONTRACTOR PRIOR TO STARTING INSTALLATION OF WATER MAIN.
 - THE CONTRACTOR SHALL COOPERATE TO THE FULLEST EXTENT WITH THE OWNER TO KEEP THE EXISTING SEWER AND WATER IN OPERATION DURING THE CONSTRUCTION OF THE PROPOSED IMPROVEMENTS. CONTRACTOR IS RESPONSIBLE TO MAINTAIN OPERATION OF ALL UTILITIES DURING PROJECT. CONNECTIONS TO EXISTING WATER MAINS WITH NEW WORK SHALL NOT BE PERFORMED UNTIL NEW WORK HAS BEEN TESTED AND ACCEPTED BY ENGINEER.
 - THE CONTRACTOR SHALL MAINTAIN TRAFFIC IN A SAFE MANNER AT ALL TIMES DURING CONSTRUCTION. SIGNAGE AND CONTROL SHALL MEET THE STANDARDS OF THE VERMONT AGENCY OF TRANSPORTATION.
 - THE CONTRACTOR SHALL BE RESPONSIBLE FOR ANY DAMAGE TO EXISTING PAVEMENT, ROADWAYS, CURBS, SIDEWALKS, GUARDRAILS, SIGNS, STRUCTURES ETC., AND SHALL REPAIR DAMAGE AT NO ADDITIONAL COST TO THE OWNER IN A MANNER APPROVED BY ENGINEER.
 - ALL AREAS BEYOND THE LIMITS OF CONSTRUCTION WHICH ARE DISTURBED BY THE CONTRACTOR SHALL BE RESTORED TO THEIR ORIGINAL CONDITION AT THE CONTRACTOR'S EXPENSE.
 - CONTRACTOR IS RESPONSIBLE TO NOTIFY LOCAL RESIDENTS AHEAD OF TIME TO ALLOW REMOVAL OF CARS, ETC., SO AS NOT TO INTERFERE WITH CONSTRUCTION OR OTHERWISE DELAY THE WORK.
 - THE WORK AREA IS WITHIN THE TOWN OF CANAAN, VT.
 - ALL WORK IS WITHIN THE HIGHWAY OR PUBLIC RIGHT-OF-WAY, UNLESS SPECIFICALLY INDICATED OTHERWISE.
 - ALL WATER PIPES ABANDONED OR SEVERED SHALL BE CAPPED, PLUGGED AND SEALED, OR REPAIRED IF LIVE.
 - TEST PITS HAVE BEEN COMPLETED ALONG THE WATER MAIN AND AT THE STORAGE TANK. LOCATIONS ARE SHOWN ON THE PLANS. DESCRIPTIONS ARE INCLUDED IN THE SPECIFICATIONS.

CANAAN FIRE DISTRICT #1
CANAAN, VERMONT
WATER STORAGE TANK

GENERAL PLAN, NOTES & LEGEND

No.	Date	Description

REVIEW SUBMITTAL NOT FOR CONSTRUCTION

TATA & HOWARD

T&H NO: 4365
 DATE: FEBRUARY 2016
 SCALE: 1" = 80'

G-1