



Vermont Department of Environmental Conservation

Agency of Natural Resources

Watershed Management Division
St. Johnsbury Regional Office
1229 Portland Street, Suite 201
St. Johnsbury, VT 05819
www.watershedmanagement.vt.gov

[fax] 802-748-6687
[cell] 802-279-1143

AUTHORIZATION TO CONDUCT STREAM ALTERATION ACTIVITIES

Pursuant to Section C.2.2 of the VT Stream Alteration General Permit (Reporting activities not requiring an application)

Project Number: SA-3-106-2016

Applicant Name: TOWN OF CABOT % KAREN DEASY

Mailing Address: P.O. Box 30 Cabot VT 05647 Phone: 563-3139

Project Location: TOWN GARAGE (OLD SITE) Email:

The Secretary of the Vermont Agency of Natural Resources (VT ANR) has determined that:

- 1. This project authorizes SEE ATTACHED RESTORATION PLAN. PROJECT IS COVERED UNDER VTSAGP C.2.2.6.
2. The proposed activity is eligible for coverage under the VT ANR Stream Alteration General Permit.
3. The proposed activity will meet the terms and conditions of the General Permit provided:
a) The project will be completed and approved as shown on the plan dated 4-5-16, prepared by KRIS JURENKUFF, and approved by the Vermont Agency of Natural Resources.
b) The project will not adversely affect the public safety by increasing flood hazards.
c) The project will not significantly damage fish life or wildlife.
d) The project will not significantly damage the rights of riparian owners.
e) The project will not obstruct the movement of aquatic life indigenous to the waterbody beyond the actual duration of construction.
f) The project is conducted in a manner which minimizes or avoids any discharge of sediment or other pollutants to surface waters in violation of the VT Water Quality Standards.
g) The ANR River Management Engineer is notified by phone or email when construction begins and when the project is complete.
h) A final construction inspection is required for all culvert and bridge projects.
i) In-stream working dates are from June 1st through October 1st; any in-stream work outside these dates will require an Individual Stream Alteration Permit authorization by the River Management Engineer.
j) This authorization has been posted for three days public comment. This authorization constitutes final approval.
k) Additional Conditions for this project:

If there are any changes in the project plan or deviation in construction from the plan, the Permittee must notify the River Management Engineer immediately.

If the project is constructed as you have described, as shown on the above referenced approved plans and according to the above conditions, there is no reason to expect any violation of Vermont Water Quality Standards.

Alyssa B. Schuren, ANR DEC Commissioner

[Signature]

Dated: 4-25-16

Patrick Ross, P.E., River Management Engineer

DATE 4-25-14
BY [Signature]

THIS APPROVAL IS SUBJECT TO THE TERMS
AND CONDITIONS OF STREAM ALTERATION
PERMIT # SA-8106-2016 ISSUED HEREWITH

- LIGHT GRASS
- DARK GRASS
- EDGE OF PAVEMENT
- TYPE OF PAVEMENT
- DRIVE
- SIDEWALK
- EXISTING FENCE
- EXISTING FENCE ENCLOSURE
- EXISTING 10' LANDSCAPE

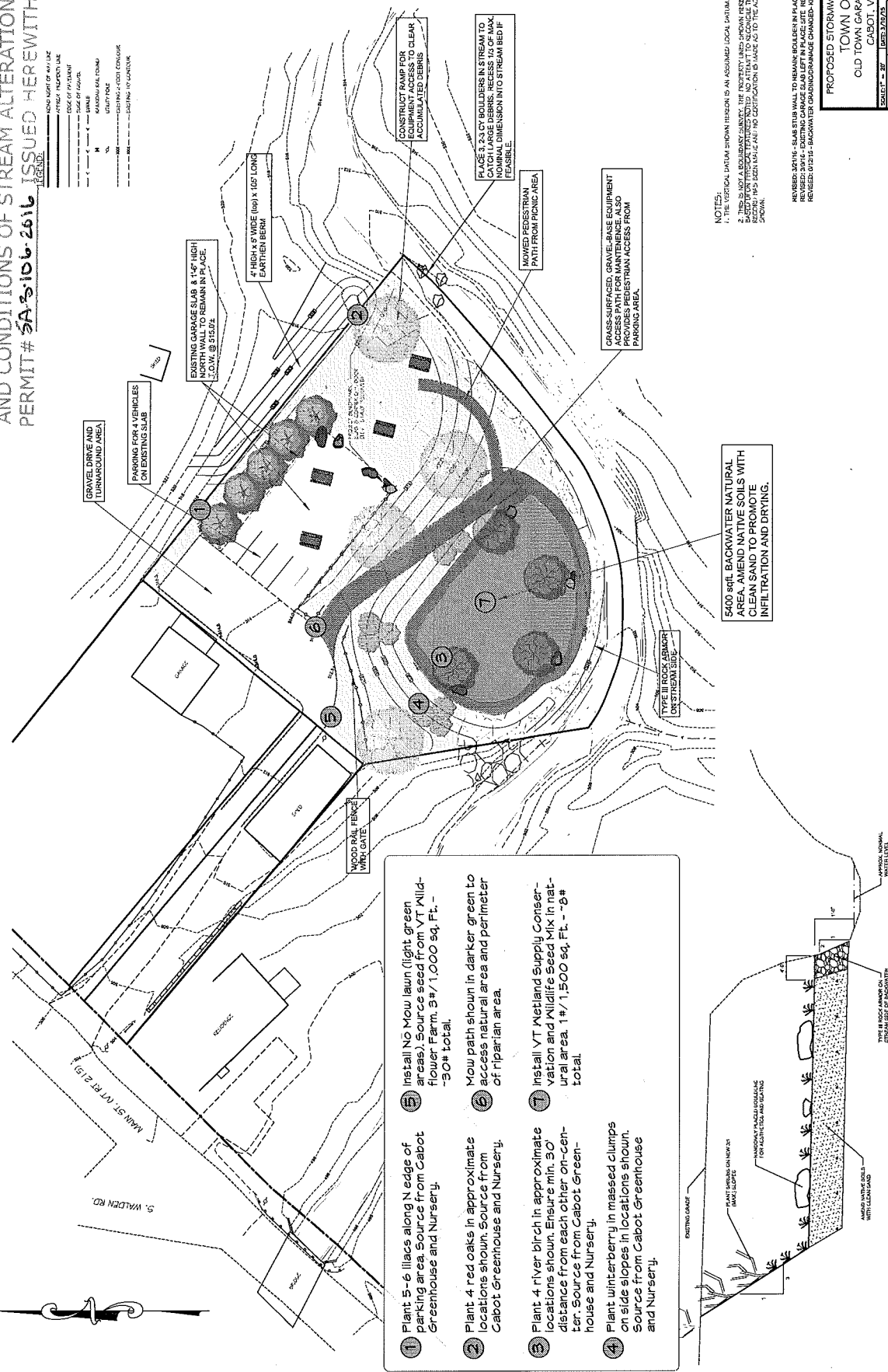

- ① Plant 5-6 lilacs along N edge of parking area. Source from Cabot Greenhouse and Nursery.
- ② Plant 4 red oaks in approximate locations shown. Source from Cabot Greenhouse and Nursery.
- ③ Plant 4 river birch in approximate locations shown. Ensure min. 30' distance from each other on-center. Source from Cabot Greenhouse and Nursery.
- ④ Plant winterberry in massed clumps on side slopes in locations shown. Source from Cabot Greenhouse and Nursery.
- ⑤ Install NO Mow lawn light green (irreversible). Source seed from VT Mill-dflower Farm. 547,1,000 sq. Ft. - 50± Total.
- ⑥ Mow path shown in darker green to access natural area and perimeter of riparian area.
- ⑦ Install VT Wetland Supply Conservation and Milllife seed mix in natural area. 1 1/2 x 1,500 sq. Ft. - 8± total.

NOTES:
1. THE VERTICAL DATUM SHOWN HEREON IS AN ASSUMED LOCAL DATUM.
2. THIS IS NOT A BOUNDARY SURVEY. THE PROPERTY LINES SHOWN HEREON ARE APPROXIMATE BASED UPON FIELD MEASUREMENTS. NO ATTEMPT TO RECONCILE DISCREPANCIES WITH THE RECORD SURVEY. THE PROPERTY LINES ARE NOT TO BE USED AS A BASIS FOR THE ACQUISITION OF THE LAND.
3. THE PROPERTY LINES ARE NOT TO BE USED AS A BASIS FOR THE ACQUISITION OF THE LAND.
4. THE PROPERTY LINES ARE NOT TO BE USED AS A BASIS FOR THE ACQUISITION OF THE LAND.

PROPOSED STORMWATER IMPROVEMENTS
TOWN OF CABOT
OLD TOWN GARAGE OFF MAIN ST.
CABOT, VERMONT

DESIGNED BY: [Signature]
CHECKED BY: [Signature]
DATE: 4-25-14

WATERSHED
CONSULTING ASSOCIATES, LLC
PO BOX 4413, BURLINGTON, VT 05409-0413

