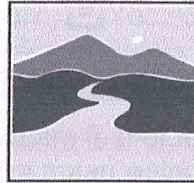

Shoreland Project Registration

Under Chapter 49A of Title 10, § 1446(a)

VERMONT DEPARTMENT OF
ENVIRONMENTAL CONSERVATION**WATERSHED
MANAGEMENT DIVISION****LAKES & PONDS PROGRAM**

For Shoreland Permitting Use Only Effective on
05/11/2016
--L.D.

Application Number: **288**

Public Recording: To prevent a potential title encumbrance, an approved copy of this registration form must be recorded in the land records of the municipality (or municipalities) in which the project is located. Be advised that registrations shall take effect 15 days after being accepted by Shoreland Permitting unless additional information is requested or the applicant is notified that an individual permit is required for the proposed project.

Submission of this registration constitutes notice that the person in Section A intends to create impervious surface and/or cleared area within the Protected Shoreland Area, and certifies that the project will comply with Chapter 49A of Title 10, § 1446(a). All information requested on this registration form must be provided, and the requisite **\$100.00** registration fee must be submitted made payable to the State of Vermont, to be deemed complete. Refer to The Vermont Shoreland Protection Act - A Handbook for Shoreland Development and related instructions for guidance in completing this registration application.

Limitation: The registration process *cannot* be used to create more than a *maximum total per parcel* of:

- **Category A:** 100 square feet of impervious surface or cleared area within 100 feet of the mean water level; and,
- **Category B:** 500 square feet of impervious surface or cleared area within the Protected Shoreland Area at least 100 feet away from mean water level.

A project may be eligible for registration as Category A, B, or both. A project within 100 feet of mean water level is considered Category A. A project at least 100 feet away is considered Category B. See page 2 for details.

A. Parcel Information1. Landowner's Name: **David Sloviter and Noryn Resnick**2a. Physical Address (911 Address): **105 Ellison's Lake Rd.**2b. Town-County: **Ludlow - Windsor**2c. Zip: **05149**3. SPAN () : **363-112-10853**4. Phone: **215.796.0252**5. Email: **dauidsloviter@aol.com**6. Name of Lake/Pond: **Lake Rescue**7. Total shore frontage: **85.00** (feet)8. Are there wetlands associated with this parcel? Yes NoContact the Wetland Program at: (802) 828-1535 or watershedmanagement.vt.gov/wetlands.htm.9. Are there previously issued shoreland permits or registrations associated with this parcel? Yes No**B. Registrant Contact Information**1. Name: **David Sloviter**2a. Mailing Address: **194 Lincoln Ave.**2b. Municipality: **Amherst**2c. State: **MA**2d. Zip: **01002**4. Phone: **215.796.0252**5. Email: **dauidsloviter@aol.com****C. Project Description**

1. Describe the proposed project. For this registration to be considered administratively complete you must include in your description dimensions and associated surface areas of proposed cleared areas and impervious surfaces and their distances from mean water level with no less than three photos attached.

The project is to replace an existing deck and expand one part of it by 96 sq. ft. The existing deck is 6 ft. by 40 ft. and has an impervious roof on it. We propose to add a section that is 4 ft. by 24 ft., also with an impervious roof. The total area of the impervious addition is 96 sq. ft. The addition will extend the deck in the direction of Lake Rescue by 4 ft. I met Laura Dlugolecki at the site on 4/20 and she confirmed the measurements of the existing impervious coverage and that only 96 sq. ft. of additional impervious is required to complete our project. I am enclosing a sketch of the proposal.

★ Is your project within 100 feet of mean water level? Yes, Go to Category A No, Skip to Category B.

Category A: 100 square feet of impervious surface or cleared area within 100 feet of mean water level:

2a. Does your project involve the creation of 100 square feet or less of impervious surface or cleared area, or a combination of both, that is within 100 feet of mean water level (MWL)? Yes No

2b. Is the impervious surface or cleared area located at least 25 feet away from the MWL? Yes No

If you answer "no" to any question (2a-2b) above, your project is not eligible for registration. Please apply for a shoreland permit.

Category B: 500 square feet of impervious surface or cleared area within the Protected Shoreland Area at least 100 feet away from mean water level:

3a. Does your project involve the creation of 500 ft² or less of impervious surface, cleared area, or a combination of both, within the Protected Shoreland Area, set back at least 100 feet from MWL? Yes No

3b. Is the slope of the project area less than 20%? Yes No

See The Vermont Shoreland Protection Act – A Handbook for Shoreland Development, Appendix B, Determining Slope

3c. Is the total impervious surface 20% or less of the parcel area (after completion of the project)? Yes No

See The Vermont Shoreland Protection Act – A Handbook for Shoreland Development, Appendix F, Calculating Percent Impervious Surface

3d. Is the total cleared area 40% or less of the parcel area (after completion of the project)? Yes No

See The Vermont Shoreland Protection Act – A Handbook for Shoreland Development, Appendix E, Calculating Percent Clearing

If you answer "no" to any question (3a-3d) above, your project is not eligible for registration. Please apply for a shoreland permit.

Advisory: Completion of this registration certifies that the applicant shall manage all the vegetative cover in accordance with the Vegetation Protection Standards, per Chapter 49A of Title 10, § 1447. Please refer to Part II of The Vermont Shoreland Protection Act - a Handbook for Shoreland Development for additional guidance. "Vegetative cover" means mixed vegetation within the Protected Shoreland Area, consisting of trees, shrubs, groundcover, and duff. It does not mean existing grass lawns, noxious weeds or nuisance plants, such as poison ivy and poison oak.

D. Landowner Certification

As the REGISTRANT, I hereby certify that the statements presented on this application are true and accurate and recognize that by signing this application, I agree to complete all aspects of the project as authorized. I understand that failure to comply with the foregoing may result in violation of the Shoreland Protection Act, 10 V.S.A. Chapter 49A, and the Vermont Agency of Natural Resources may bring an enforcement action for violations of the Act pursuant to 10 V.S.A. Chapter 201.

Registrant/Landowner Signature: _____

David Shorter

Date: *4-20-16*

Print Form

Submit this registration form and \$100.⁰⁰ fee to:
Vermont Department of Environmental Conservation
Watershed Management Division
Shoreland Permitting
1 National Life Drive, Main 2
Montpelier, VT 05620-3522

Direct all correspondence or questions to Shoreland Permitting at:
ANR.WSMDShoreland@vermont.gov
 For additional information visit: www.watershedmanagement.vt.gov

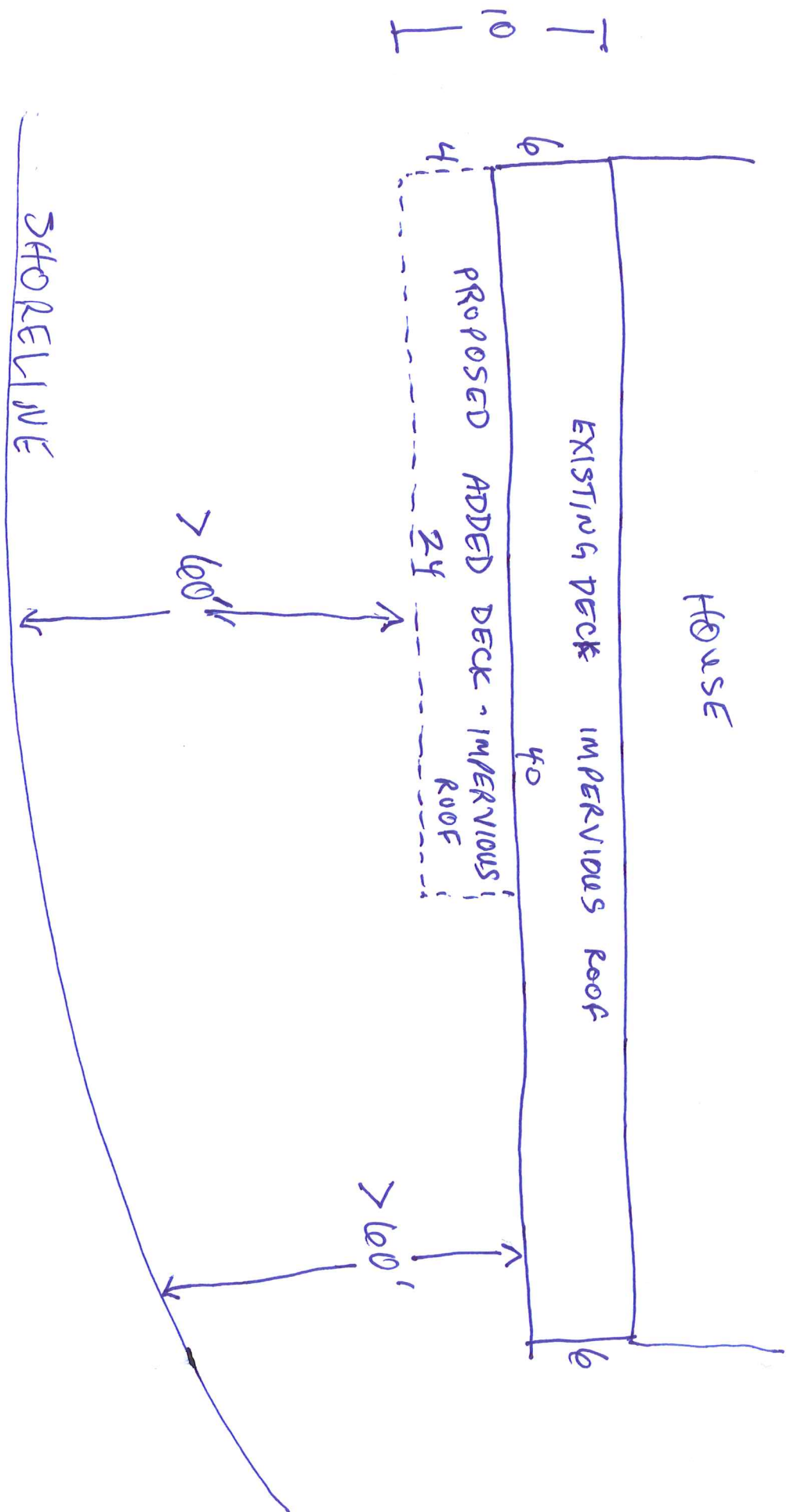

LAKE RESERVE

THE EXISTING DECK WILL BE REMOVED AND A NEW DECK CONSTRUCTED TO THE DIMENSIONS SHOWN ABOVE

DAVID SLOVITER
 215.796.0252
 4/20/16 David Sloviter