



Shoreland Project Registration Application

Under Chapter 49A of Title 10, § 1441 et seq.



For Shoreland Permitting Use Only Effective
 Application Number: **2150-SR** 10/27/2016--L.D.

Public Recording: To prevent a potential title encumbrance, an approved copy of this registration form must be recorded in the land records of the municipality (or municipalities) in which the project is located. Be advised that registrations shall take effect 15 days after being accepted by Shoreland Permitting unless additional information is requested or the applicant is notified that an individual permit is required for the proposed project.

Submission of this registration constitutes notice that the person in Section A intends to create impervious surface and/or cleared area within the Protected Shoreland Area, and certifies that the project will comply with Chapter 49A of Title 10, § 1446(a). All information requested on this registration form must be provided, and the requisite **\$100.00** registration fee must be submitted made payable to the State of Vermont, to be deemed complete. Refer to The Vermont Shoreland Protection Act - A Handbook for Shoreland Development and related instructions for guidance in completing this registration application.

Limitation: The registration process *cannot* be used to create more than a *maximum total per parcel* of:

- **Category A:** 100 square feet of impervious surface or cleared area between 25 feet and 100 feet of the mean water level; and
- **Category B:** 500 square feet of impervious surface or cleared area between 100 feet and 250 feet from mean water level.

A project may be eligible for registration as Category A, B, or both. A project within 100 feet of mean water level is considered Category A. A project at least 100 feet away is considered Category B. See page 2 for details.

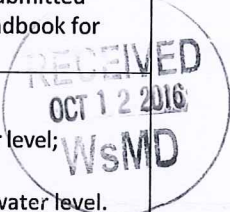

A. Parcel Information

1. Landowner's Name: ROGER W. WILDE	
2a. Physical Address (911 address): 132 Fishing Road	
2b. Town - County: Woodbury / Washington	2c. Zip: 05681
3. SPAN (The School Parcel Account Number is required for your application to be deemed complete. It can be obtained from your property tax bill. If you cannot locate your property tax bill, please obtain this information from your Town Clerk) : 780-248-10582	
4. Phone: 802-456-8919	5. Email:
6. Name of Lake/Pond: Volley Lake	7. Total shore frontage: 125 (feet)
9. Are there wetlands associated with this parcel? <input type="checkbox"/> Yes <input checked="" type="checkbox"/> No <small>Contact the Wetlands Program (802) 828-1535 or http://dec.vermont.gov/watershed/wetlands</small>	
10. Are there previously issued Shoreland permits or registrations associated with this parcel? <input type="checkbox"/> Yes <input checked="" type="checkbox"/> No	

B. Registrant Contact Information

1. Name: Roger W. Wilde	
2a. Mailing Address: 16 Stearns St	
2b. Town: Chelmsford	2c. State: MA
3. Phone: (local) 456-8919	2d. Zip: 01824
4. Email:	

C. Project Description

1. Describe the proposed project. For this registration to be considered administratively complete you must include in your description dimensions and associated surface areas of proposed cleared areas and impervious surfaces and their distances from mean water level.

This project involves a 10' by 10' addition to a 10' by 16' deck approved in 2014. The deck is located on a patio, approximately 42 feet from the lake's edge. The camp is on a .29-acre lot and was constructed in 1958. No additional clearing of vegetation will be necessary. See attached site plan

2. Is your project between 25 feet and 100 feet from mean water level?
 Yes, Go to Category A No, Skip to Category B

Category A
(between 25 feet and 100 square feet of impervious surface or cleared area between 25 feet and 100 feet of Mean Water Level)

2a. Does your project involve the creation of 100 square feet or less of impervious surface or cleared area, or a combination of both, that is within 100 feet of mean water level (MWL)? Yes No
2b. Is the impervious surface or cleared area located at least 25 feet away from the MWL? Yes No

If you answer "no" to any question (2a-2b) above, your project is not eligible for registration. Please apply for a Shoreland Permit.

Category B
(500 square feet of impervious surface or cleared area between 100 feet and 250 feet from Mean Water Level)

3a. Does your project involve the creation of 500 ft² or less of impervious surface, cleared area, or a combination of both, within the Protected Shoreland Area, located at least 100 feet from MWL? Yes No
3b. Is the slope of the project area less than 20%? Yes No
See The Vermont Shoreland Protection Act – A Handbook for Shoreland Development, Appendix B, Determining Slope
3c. Is the total impervious surface 20% or less of the parcel area (after completion of the project)? Yes No
See The Vermont Shoreland Protection Act – A Handbook for Shoreland Development, Appendix F, Calculating Percent Impervious Surface
3d. Is the total cleared area 40% or less of the parcel area (after completion of the project)? Yes No
See The Vermont Shoreland Protection Act – A Handbook for Shoreland Development, Appendix E, Calculating Percent Clearing

If you answer "No" to any question (3a-3d) above, your project is not eligible for registration. Please apply for a Shoreland Permit

Advisory: Completion of this registration certifies that the applicant shall manage all the vegetative cover in accordance with the Vegetation Protection Standards, per Chapter 49A of Title 10, § 1447. Please refer to Part II of The Vermont Shoreland Protection Act - a Handbook for Shoreland Development for additional guidance. "Vegetative cover" means mixed vegetation within the Protected Shoreland Area, consisting of trees, shrubs, groundcover, and duff. It does not mean existing grass lawns, noxious weeds or nuisance plants, such as poison ivy and poison oak.

D. Landowner Certification

As the REGISTRANT, I hereby certify that the statements presented on this application are true and accurate and recognize that by signing this application, I agree to complete all aspects of the project as authorized. I understand that failure to comply with the foregoing may result in violation of the Shoreland Protection Act, 10 V.S.A. Chapter 49A, and the Vermont Agency of Natural Resources may bring an enforcement action for violations of the Act pursuant to 10 V.S.A. Chapter 201.

Registrant/Landowner Signature: _____

Date: _____

Submit this registration form and \$100.⁰⁰ fee to:

Vermont Department of Environmental Conservation
Watershed Management Division
Shoreland Permitting
1 National Life Drive, Main 2
Montpelier, VT 05620-3522

Direct all correspondence or questions to Shoreland Permitting at:

ANR.WSMDSshoreland@vermont.gov

For additional information visit: <http://dec.vermont.gov/watershed>

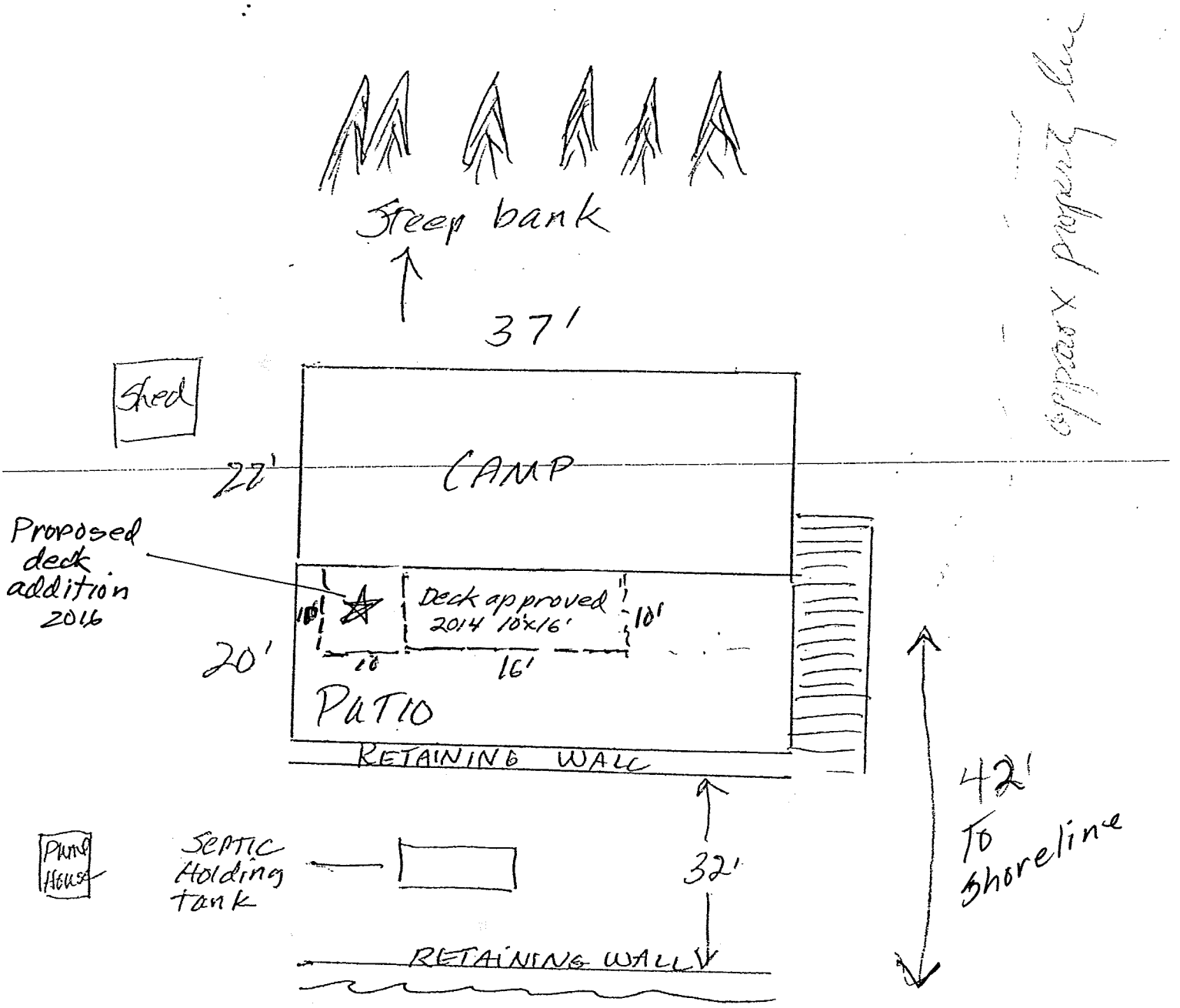

Lot is .29 acres
 on Valley Lake - access by a
 private camp road

ok