



Individual Permit Application
For a **Lake Encroachment Permit** under

Chapter 11 of Title 29, § 401 *et seq.*

For Lake Encroachment Permitting Use Only

Application Number: 2016-011

Submission of this application constitutes notice that the person in Section B intends to encroach beyond the mean water level of a lake or pond, and certifies that the project will comply with Chapter 11 of Title 29, § 401 *et seq.* All information required on this form must be provided, and the requisite fees (Section I) must be submitted made payable to the State of Vermont, to be deemed complete.

A. Project Information

1. Physical Address (911 Address): 231 Greenwood Lake Road

2a. Town- County: Woodbury - Washington

2b. Zip: 05681

3. Span (School Parcel Account Number is required for your application to be deemed complete. It can be obtained from your property tax bill. If you cannot locate your property tax bill, please obtain this information from your Town Clerk)

780-248-10658

4. Name of Lake/Pond: Greenwood Lake - Woodbury

5. Have you ever applied for a permit with the Department of Environmental Conservation associated with this parcel? Yes No

B. Applicant (Landowner if applicable) Contact Information

1. Name: Steven and Carole Fowler

2a. Mailing Address: 231 Greenwood Lake Rd

2b. Town: Woodbury

2c. State: VT

2d. Zip: 05681

3. Phone: 802-472-7026

4. Email: fishhog231@comcast.net

C. Application Preparer Contact Information:

1. Name: Carole Fowler

2a. Mailing Address: 231 Greenwood Lake Road

2b. Town: Woodbury

2c. State: VT

2d. Zip: 05681

3. Phone: 802-472-7026

4. Email: fishhog231@comcast.net

D. Abutting Land Owners

Using the abutter addendum available on dec.vermont.gov, attach a list of land owners who abut the proposed project.

E. Project Description

1. Describe the proposed project including the description of the materials and mechanical equipment which may be used during construction and the anticipated work schedule. Identify whether or not the project includes placement or removal of fill and if so, specify the number of cubic yards of fill or dredged materials to be placed or removed beyond the shoreline at mean water level.

Anticipated work schedule: Sometime during 08/15/2016 - 09/15/2016 or next same time year

Utilize a subcompact utility tractor to dig trenches for supports/bracing, also to move some stone and lift/place lumber near waters edge.

Construct a retaining wall made of 2 x 12s and 2 x 4s to prevent further soil erosion. <5 cu yds of fill may be necessary. Planting of vegetation will occur following construction.

2. Describe the purpose of the proposed project:

To prevent further soil erosion. We've lost at least 12" of shoreline in the past 15 years due to soil erosion from frost, ice and waves.

3. Describe what less intrusive feasible alternatives have been considered:

Over the past fifteen years, I have repeatedly retrieved rocks and pebbles that have rolled back into the lake and put the stones back against the shoreline. I constructed a stone retaining wall, just to have it 75% destroyed by ice, frost and waves. I planted lilac bushes in one area, that will soon be lost due to the continued soil erosion.

4. Describe the public benefits of the proposed project:

The proposed project will remove the hazards of unstable boulders and sharp rocks, thereby improving the public safety of lakeside access. This is a private lakeside home and we would like to make this improve for the safety of family and friends who visit. It will improve access for kayaking and boating as well.

F. Encroachment Effects (describe how the proposed project will affect the following)

1. What measures are proposed to minimize the project's effects on water quality (e.g., use of a turbidity curtain)?

Every attempt will be made to minimize this projects affect on water quality.

2. How will the project minimize effects to fish and wildlife habitat (e.g., project is not to commence until after fish spawning July 1 of any calendar year)?

As required the project construction schedule will start following completion of public notice (mid-August). Allowing sufficient time for minimal effects on the spawning, hatching and growth of fisheries and wildlife (snapping turtles, beavers, loons, weasels, kingfishers, etc.)

3. Does the project propose removal of aquatic or shoreline vegetation? If so, what measures are proposed to reduce the effects of vegetation removal?

No.

4. Describe the surrounding shoreline. Is the project consistent with these surroundings? What measures are proposed to ensure the project is in-keeping with the surroundings?

The one abutting seasonal neighbor has no erosion control measures and is also losing property. Three other seasonal properties each have either a boulder, fieldstone or lumber retaining wall. An abutting property has a "flat, private" access area with no soil erosion measures. Across the lake, along the County Road, are all large boulders inserted by the municipality in order to save the roadside from erosion. Guardrails were also recently installed in the sharp turns along the County Road. Our proposal, in my opinion, will be "keeping-in" with the surroundings.

5. Will the project affect navigation, recreation, and other public uses? If so, how will these effects be minimized?

No.

G. Applicant Certification

As APPLICANT, I hereby certify that the statements presented on this application are true and accurate and recognize that by signing this application, I agree to complete all aspects of the project as authorized. I understand that failure to comply with the foregoing may result in violation of the Chapter 11 of Title 29, § 401 *et seq.*, and the Vermont Agency of Natural Resources may bring an enforcement action for violations of the Act pursuant to 10 V.S.A. chapter 201.

Applicant (landowner if applicable) Signature: Carole Fowler Date: 05/13/2016

I. Applicant Preparer Certification (if applicable)

As APPLICATION PREPARER, I hereby certify under penalty of law that this document and all attachments were prepared under my direction or supervision in accordance with a system designed to assure that qualified personnel properly gathered and evaluated the information submitted. Based on my inquiry of the person or persons who manage the system, or those persons directly responsible for gathering the information, the information submitted is, to the best of my knowledge and belief, true, accurate, and complete. I am aware that there are significant penalties for submitting false information, including the possibility of fine and imprisonment for knowing violations.

Application Preparer Signature: Carole Fowler Date: 05/13/2016

J. Additional Required Documentation: (please check to ensure you have completed the following)

- All sections of the application are complete or otherwise indicate "not applicable";
- Application includes site plans with aerial and cross section views;
- Application description includes dimensions and surface areas of cleared areas and impervious surfaces; and
- Application includes photos of project area.

K. Permit Application Fees		
Select the most applicable permit description and requisite fee. If the proposed project involves more than one of the project types, multiple fees may apply. For example, a project involving structural erosion control and marina improvement will require both fees (2) and (3).		
1. Non-structural erosion control project (e.g., rip rap):		
Non-structural erosion control project: \$155.00		
Total:		
2. Structural erosion control project		
Structural erosion control project: \$250.00		\$250
Total:		\$250
3. Other Projects (e.g., marina improvements):		
Other Project: \$300.00		
Project Cost Fee: 0.01 times project cost	Total Project Cost: _____ x 0.01	
Total:		

Submit this form and application fee, payable to:
State of Vermont
Vermont Department of Environmental Conservation
Watershed Management Division
1 National Life Dr, Main 2
Montpelier, VT 05620-3522

Direct all correspondence or questions to Lake Encroachment Permitting at:
ANR.WSMDShoreland@vermont.gov

For additional information visit: <http://dec.vermont.gov/watershed/lakes-ponds>



VERMONT DEPARTMENT OF ENVIRONMENTAL CONSERVATION
WATERSHED MANAGEMENT DIVISION
 LAKES & PONDS PROGRAM

Lake Encroachment Application Addendum

For a Lake Encroachment Permit

Chapter 11 of Title 29, § 401 *et seq.*

This Abutting Land Owner Addendum is intended to accompany a completed *Lake Encroachment Permit Application* in instances of a proposed lake encroachment abutting land owners other than the applicant.

I. Abutting Land Owner Information

1. Name: Robert Lord Jr (parcel 12-62)

Address: c/o Living Trust, 601 Cummings Road, Barre VT 05641

2. Name: Donald & Carissa Smith (parcel 12-60)

Address: 134 Donny Smith Drive, Randolph Center VT 05061

3. Name: Betty Davis, Retta Dunlap & Arlene Cerutti (parcel 15-40)

Address: Box 24, Woodbury VT 05681-0024 (parcel 15-40)

4. Name: Rilla Roberson, Margaret Green & Melissa Sargent (parcel 15-41)

Address: 20 Greenwood Lake Rd, Woodbury VT 05681

5. Name: Ralph and Martha Knight

Address: 2392 Allen Court, Lantana FL 33462

6. Name:

Address:

7. Name:

Address:

8. Name:

Address:

9. Name:

Address:

10. Name:

Address:

Submit this form as an addendum to a complete Lake Encroachment Application to:

State of Vermont
 Vermont Department of Environmental Conservation
 Watershed Management Division
 Lake Encroachment Permitting 1
 National Life Drive, Main 2
 Montpelier, VT 05620-3522

Direct all correspondence or questions to Lake Encroachment Permitting at:
ANR.WSMDShoreland@vermont.gov

For additional information visit: <http://dec.vermont.gov/watershed>

GREENWOOD LAKE

Woodbury, Vt.
 from Tax Map
 Di. Sawyer 4/07



Boundaries —
 Camp Roads - - - -



Scale 1:5000
 (1 in. = 417 ft.)

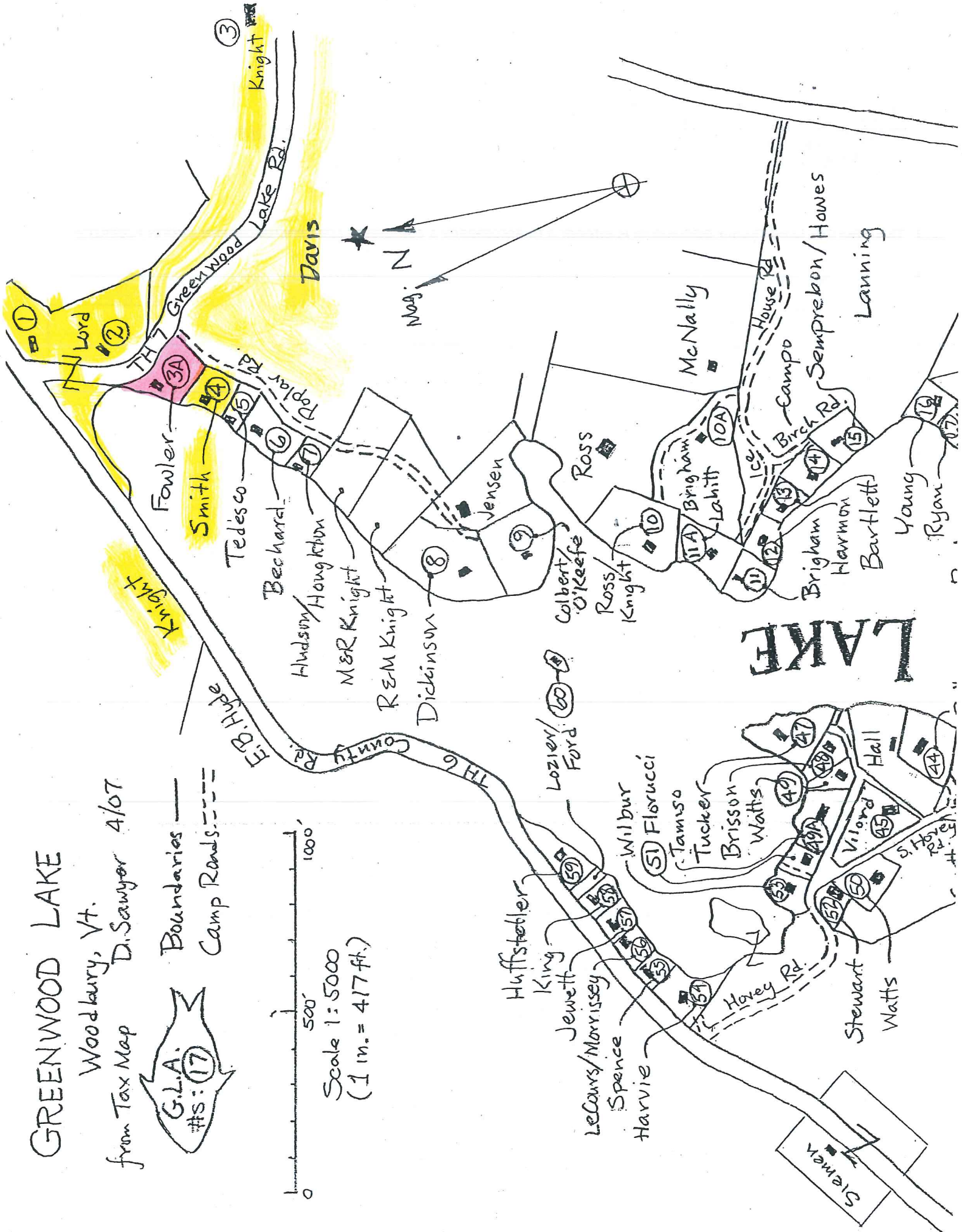

Poplar Rd
↙

County Rd
↘



↑
Greenwood Lake Rd

Poplar Rd



County Rd

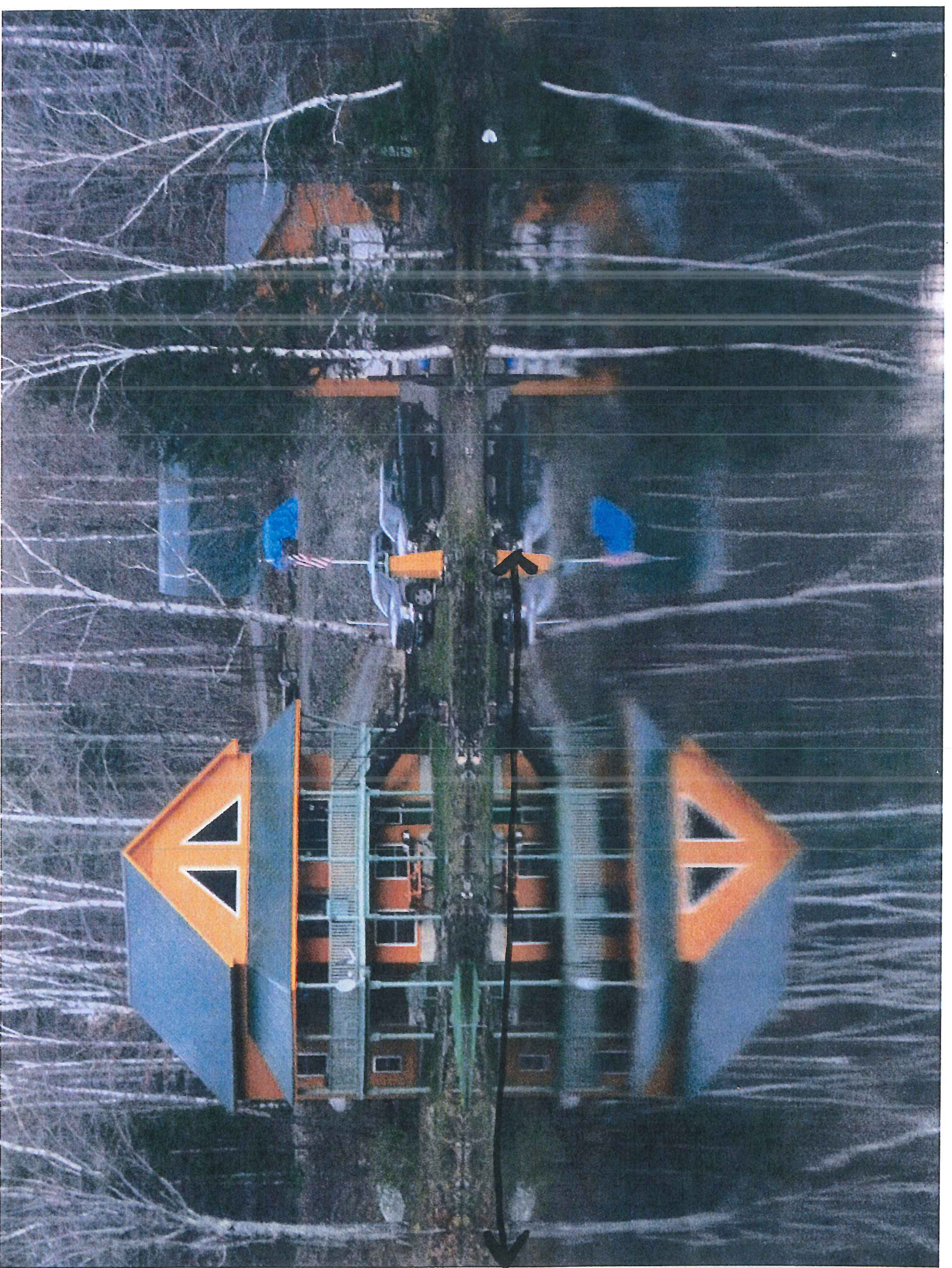



↑
All these
Stones are
manually
lifted out
each year.

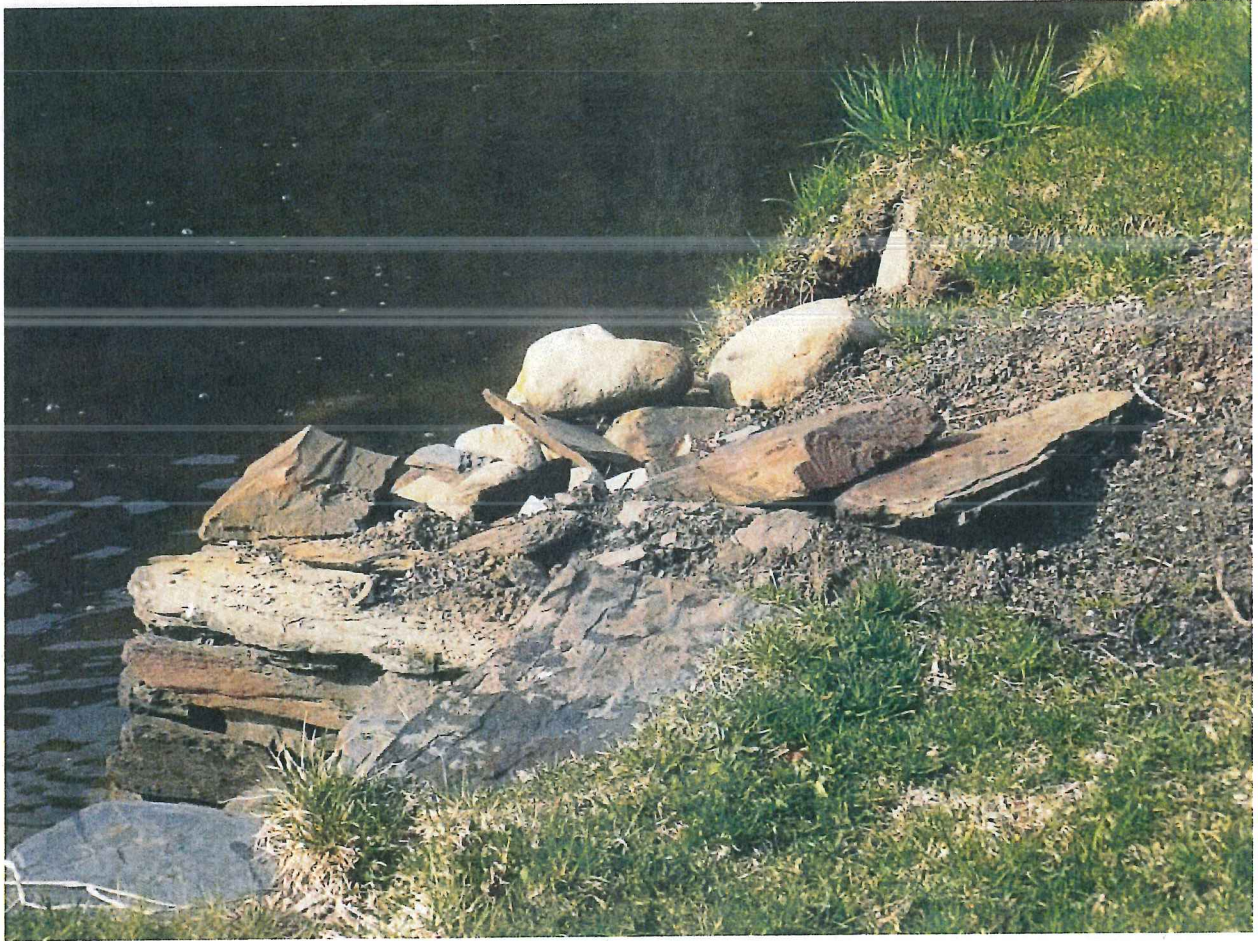



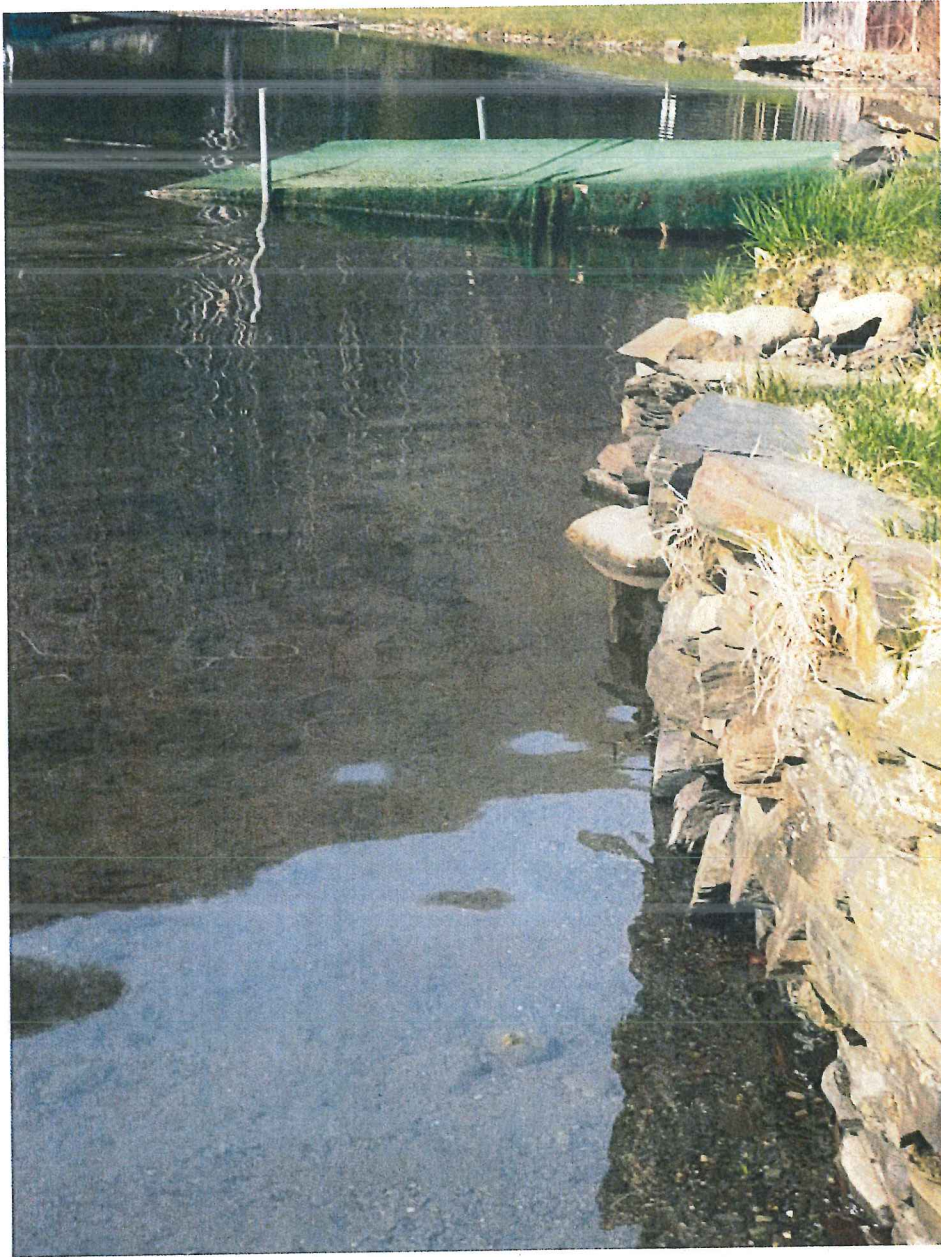



Rusted pipe that once held a log used for a retaining wall.

Rocks in the water are physically lifted out each year.

Neighbor 4 - Flat
no trees
no vegetation
no walls



↑
has dropped due
to loss of 12" of land

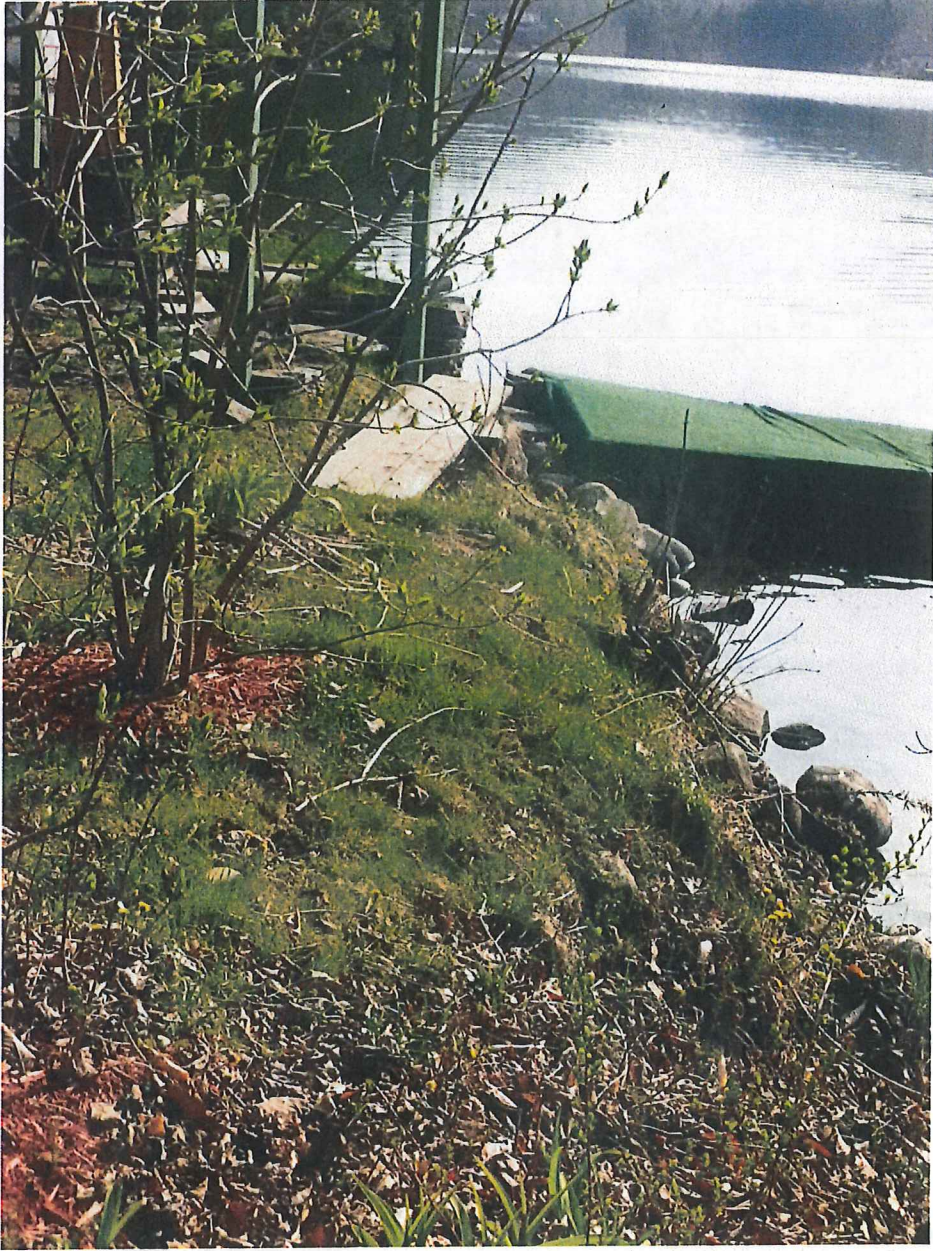



County Rd



Town
Added
Guardrails
↓

County Rd

Boulders added by Town
to save road from
erosion



- Neighbor 1 - Smith
greater than 12" lost
Rusted pipe shows where
a log was once held

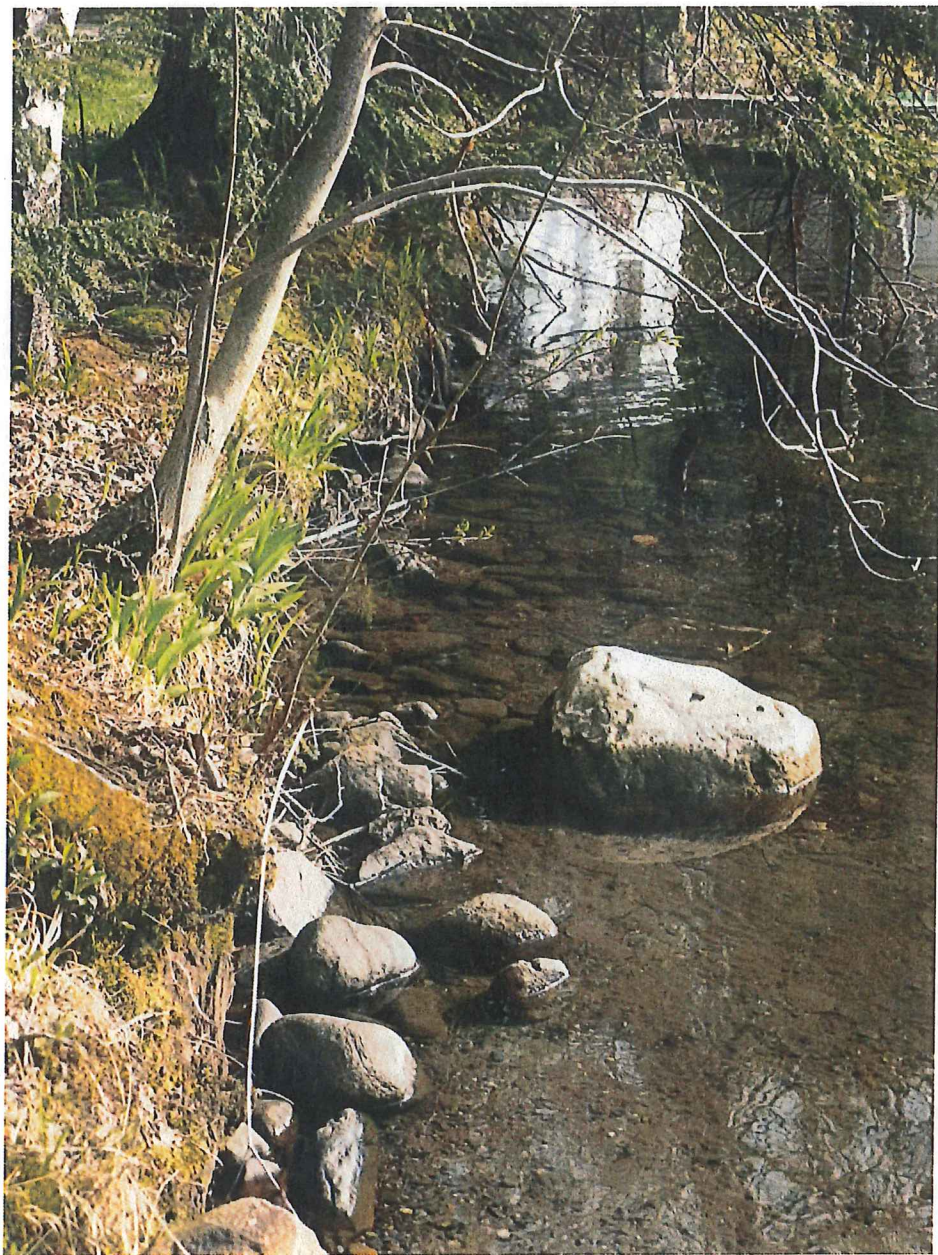



Neighbor 1 -

About to lose their 3rd tree

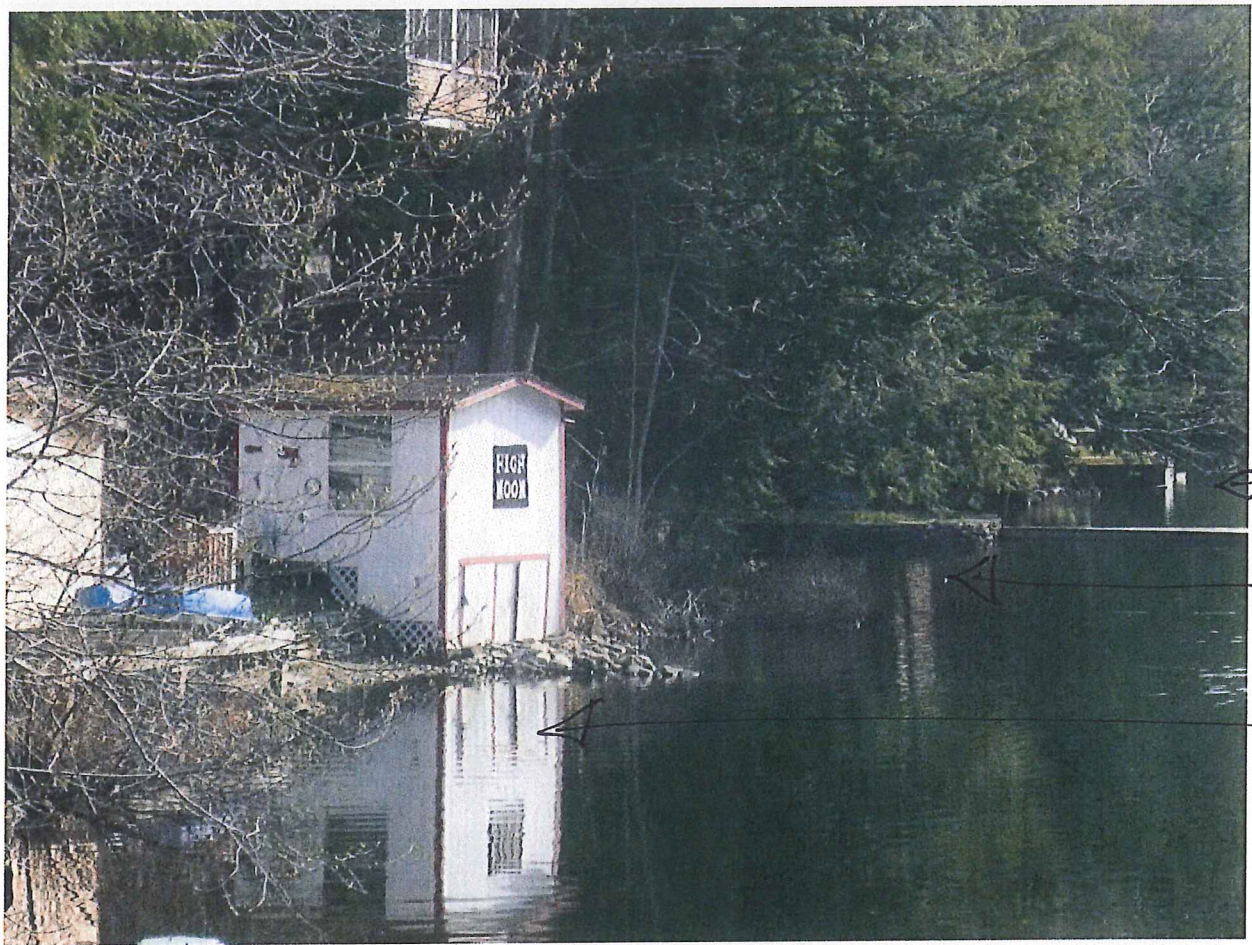

Next three camps

- 1- Boulder walls
- 2- field stone walls
- 3- lumber retaining wall

